

Product Catalogue



Commercial and Engineered Sound Products

4 INPUT CHANNEL - BGM/FGM INTEGRATED AMPLIFIERS

Absolute Performance - The Series 3000 is an extremely versatile line of Integrated Amplifiers. The unique features provided in all models are easily adaptable to most sound applications. The numerous connectivity possibilities, indicate the powerful functions available and stimulate the creativity of the designing applications engineer on providing the best and the most cost effective solution for a given project. The most popular series selected for music background applications. Proven field reliability in thousands of installations. Trouble-free continuous operation under extreme environmental conditions. Total versatility meets most demanding applications for music, paging and music or messaging on hold. The Amplifier is fully protected against overloads and short circuit with automatic reset in case of a short or overload. Rack mounting is possible by using the optional Rack Kit available as an accessory (see accessories).

MODELS

T3115BGM - 15 W INTEGRATED AMPLIFIER

T3130BGM - 30 W INTEGRATED AMPLIFIER



27/3500 - Standard 19" Rack Mounting Kit. Complete with hardware. Black Finish. 2 Units of Rack vertical space.

- ULTRA WIDE POWER BANDWIDTH
- VERY LOW DISTORTION CHARACTERISTICS
- HIGH RELIABILITY/EXCEPTIONAL PERFORMANCE
- 4 CHANNEL INPUTS - 2 ZONE OUTPUTS
- BUILT-IN TELEPHONE PAGING INTERFACE
- BALANCED MICROPHONE INPUT
- PHANTOM POWER ON MIC INPUT
- BALANCED PROGRAM INPUT
- BUILT-IN JUKEBOX SWITCHER
- INDEPENDENT PHONE PAGING LEVEL CONTROL
- AUX INPUT WITH STEREO SUMMING
- AUX INPUT WITH SENSITIVITY CONTROL
- MUSIC ON HOLD 600 OHM BALANCED OUTPUT
- INDEPENDENT MOH & 2ND ZONE OUTPUT
- ZONE 2 - 1 WATT 8 OHM OUTPUT
- ADDRESSABLE VOX - VOICE ACTIVATED MUTING
- DIRECT MUTING AND UNMUTING
- POWER SURGE AND OVERLOAD PROTECTION





EXCEPTIONAL RELIABILITY - OUTSTANDING SONIC PERFORMANCE



FEATURES AND FUNCTIONS

INPUT 1

Microphone Input

Low Impedance Microphone Input. Impedance is 250 ohm balanced and this input can be muted or unmuted (see Muting/Unmuting function).

INPUT 2

Telephone Paging Input

Input 2 provides Telephone Paging Interface. Input Impedance is 600 ohm Transformer balanced. A rear panel Output Level Control is provided..

INPUT 3

Auxiliary Input

Input 3 can be AUX, CD or SATELLITE RECEIVER Input. The AUX Input impedance is 47K ohm unbalanced.

INPUT 3 ATTENUATOR

A rear panel Variable Attenuator is provided to set the Sensitivity Threshold of this input. By adjusting the Attenuator the sensitivity may be changed from 100 Mv to 5 Volt.

STEREO SUMMING - Two separate RCA Jacks are provided for Input 3 (Left and Right). A Stereo signal connected to either Input is buffered and internally summed to Mono.

INPUT 4

Program Input

Balanced Program Input may be used as a Satellite Receiver Input, Message Repeater Input or Line Input.

CONTROLS

Front Panel Controls - Microphone, Auxiliary, Program, Bass and Treble

Rear Panel Controls - Telephone Output Level, AUX Attenuator and MOH/ZONE 2 Output Level.

VOX - Voice Activated Muting - The VOX Muting System is activated by the Microphone Input or the Telephone Input and mutes the AUX and PROGRAM Inputs.

ADDRESSABLE VOX - The AUX INPUT and the PROGRAM INPUT may be Muted or not Muted by internal Jumper. If the MUTE is ON (can be selected independently for AUX and PROGRAM) a Page from the Microphone or Telephone will mute either the AUX or the PROGRAM INPUT or both.

DIRECT UNMUTING - The MICROPHONE Input can be set to be normally MUTED (by internal jumper) until activated by contact closure of the UNMUTE and G Terminals.

MUSIC ON HOLD OUTPUT - Provides a 1 Volt, 600 ohm, Transformer balanced output for Music/Message on Hold. Internal jumper selects the source from either Aux Input or Program Input. Level Control is provided. Not affected by paging or muting.

ZONE 2 OUTPUT - Provides a 1 Watt, 8 ohm output for Zone 2 Speaker Output. Internal jumper selects the source from either Aux Input or Program Input. Level Control is provided. Not affected by paging or muting.

AC ACCESSORY OUTLET - 500 Watt unswitched.

ACCESSORIES

27/3500 - Standard 19" Rack Mounting Kit. Complete with hardware. Black Finish. Occupies two units of vertical rack space.

4 INPUT CHANNEL - PROFESSIONAL INTEGRATED AMPLIFIERS

Absolute Reliability - The DMA SERIES is like no other Amplifier Line. Every component utilized is Heavy-Duty. Built tough to take the daily punishment required for continuous operation. DMA delivers Outstanding Sonic Performance at any level of rated power and with any Speaker System Load. Breakthrough Technology is applied to every critical Circuitry from Power Surge Protection and Speed Controlled Fans for Thermal Protection to massive High Current Power Supplies. The Load Management System has the ability to adapt the power transfer to specific speaker loads. By delivering more current on demand to the Output Stages when Peak Power is needed the Amplifier will automatically provide the additional Reserve Headroom required. Sound purity is maintained with lower distortion for "Heavier Bass" and "Clearer Highs". Four models from 15 Watt to 120 Watt.



- ULTRA WIDE POWER BANDWIDTH
- VERY LOW DISTORTION CHARACTERISTICS
- HIGH RELIABILITY/EXCEPTIONAL PERFORMANCE
- ADDRESSABLE VOX AND MUTING SYSTEM
- INDEPENDENT MOH & 2ND ZONE OUTPUT
- INTELLIGENT INPUT/OUTPUT VERSATILITY
- AUTOMATIC LOAD MANAGEMENT SYSTEM
- 24 VOLT DC AUXILIARY POWER SUPPLY
- POWER SURGE AND OVERLOAD PROTECTION
- BUILT-IN JUKEBOX SWITCHER
- BUILT-IN ZONE PAGING SYSTEM
- BUILT-IN TELEPHONE PAGING INTERFACE

MODELS

DMA2015 - 15 W INTEGRATED AMPLIFIER

DMA2030 - 30 W INTEGRATED AMPLIFIER

DMA2060 - 60 W INTEGRATED AMPLIFIER

DMA2120 - 120 W INTEGRATED AMPLIFIER

DMA SETS NEW STANDARDS FOR DIGITAL MUSIC REPRODUCTION





EXCEPTIONAL RELIABILITY - OUTSTANDING SONIC PERFORMANCE



Input 1 is a Microphone Input. Impedance is 250 ohm electronically balanced.

Input 2 is Phone Paging to interface with a Phone System. Input Impedance is 600 ohm, Transformer Balanced. A level control is available on the Front Panel.

Phantom Power - Provided on all Inputs set as MIC provided for Input 3 and 4 (Left and Right). A Stereo signal connected to either Input is buffered and internally summed to Mono.

Input 3 & 4 Attenuators - When the Inputs are set as AUX 1 and AUX 2 the input sensitivity may be varied by a rear panel Variable Attenuator. This feature allows to set the output level of Programs originating from different sources (CD, Satellite Receiver, etc.).

MIX BUSS - This Input/Output may be utilized to parallel two amplifiers or as an input for a Microphone Mixer or other audio source. When used as an Input the Amplifier Level and Equalization Controls have no effect.

Remote Volume Control - The INPUT 3/AUX 1 Input Volume may be adjusted from a remote location. Remote Volume Inputs utilize a 10K Pot and are immune to Audio Interference (DC Operation).

Addressable VOX System - The VOX System can be individually selected to operate independently on all 4 Inputs.

Addressable Muting System - All Inputs may be set to be Muted when the Vox is activated.

Direct Muting/Unmuting System - The MUTE function may be activated by external contacts. MIC 1 Input may be set to normally off and turned-on by shorting the Unmute Terminals.

Music on Hold - Output Channel 1- Channel 1 provides a 1 Volt, 600 ohm Transformer Balanced Output. Internal Jumper selects the source from either AUX 1 or AUX 2. Level Control is provided.

Output Channel 2 - Channel 2 provides a 2 Watt Max., 8 ohm output for Zone 2 Speaker Output. Internal Jumper selects the source from either AUX 1 or AUX 2. Level Control is provided.

Tone By-Pass Switch - The Tone by-pass switch defeats the setting of the Treble and Bass Controls. Should be used when an External Equalizer is utilized.

24 VDC Supply Output - A 24 Volt DC, 250 mA regulated Power Supply with dynamic filter is provided for external accessories.

ACCESSORIES



27/3500 - Standard 19" Rack Mounting Kit. Complete with hardware. Black Finish. 2 Units of Rack vertical space.



AC3 - Programmable Multi-Tone Chime Module, Internal Plug-in Card. Mounts on main printed circuit board of Amplifier. Provides eight Electronic Chime Tones and Westminster. DIP-Switch Programming and Output Level Trimmer. Tone is triggered each time the Mute terminals are closed.

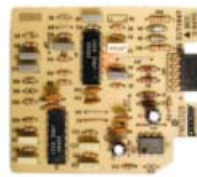

PMEQ16B - Internal Plug-in EQ Module. Mounts on main printed circuit board of Amplifier. Provides equalization for the BOSE® System 16 Speaker System.

PMEQ32B - Internal Plug-in EQ Module. Mounts on main printed circuit board of Amplifier. Provides equalization for the BOSE® System 32 Speaker System.



RVC10W - Remote Volume Control for Amplifiers. Decora Style Plate mounts on standard single Gang Box. Complete with mounting hardware. Control Potentiometer: 10 K Ohm • Termination: 4" Pigtail, stripped and tinned • Dimensions: 4.5" H, 2.75" W, 0.6" Behind Front Plate. (115X70X16 mm) • Net Weight: 3 oz (0.088 Kg)

5 INPUT CHANNEL - PROFESSIONAL INTEGRATED AMPLIFIERS

Absolute Versatility - Never before a Series of Amplifiers so ingeniously engineered has been offered to the Modern Systems Integrator. Addressing the requirements of today's demanding installations, DMAB meets those needs beautifully, totally and with innovation and cost effectiveness unequalled by any other competitive system available. The advanced technology utilized in the electro-mechanical integration of all internal components affords High Performance, Superb Quality and Extreme Reliability in a rugged, compact package. The Load Management System has the ability to adapt the power transfer to specific speaker loads. By delivering more current on demand to the Output Stages when Peak Power is needed the Amplifier will automatically provide the additional Reserve Headroom required. Sound purity is maintained with lower distortion for "Heavier Bass" and "Clearer Highs". Five models are available from 15 Watt to 260 Watt in only 2U of Rack space.



CONVERTIBLE INPUTS - PHOENIX CONNECTORS - REAR PANEL PROGRAMMING

MODELS

DMA2015B - 15 W INTEGRATED AMPLIFIER
DMA2030B - 30 W INTEGRATED AMPLIFIER
DMA2060B - 60 W INTEGRATED AMPLIFIER

- ✿ HIGH PERFORMANCE MULTI MEDIA INTEGRATED AMPLIFIERS
- ✿ PHOENIX CONNECTORS
- ✿ DIP SWITCH REAR PANEL PROGRAMMABLE
- ✿ FIVE CHANNEL FULLY ADDRESSABLE INPUTS
- ✿ THREE AUX INPUTS - RCA CONNECTORS
- ✿ 600 OHM TRANSFORMER BALANCED PHONE PAGING INPUT
- ✿ ALL CHANNEL REMOTE VOLUME CONTROL CAPABILITY
- ✿ MASTER REMOTE VOLUME CONTROL
- ✿ MULTISOURCE INPUTS CONTROLLER USING CAT 5 CABLING
- ✿ ALL CHANNEL INPUT SENSITIVITY CONTROL
- ✿ PORT FOR INPUT/OUTPUT AUDIO MODULES

DMA2120B - 120 W INTEGRATED AMPLIFIER
DMA2260B - 260 W INTEGRATED AMPLIFIER

- ✿ VOX ACTIVATED RELAY WITH NO/NC CONTACTS
- ✿ BUILT-IN REMOTE CONTROL ROOM COMBINING SYSTEM
- ✿ BUILT-IN ZONE PAGING SYSTEM
- ✿ AUTOMATIC LEVEL CONTROL/COMPRESSORS ON AUX 2, 3 AND 4
- ✿ WIDE POWER BANDWIDTH AND VERY LOW DISTORTION
- ✿ 2ND 3 WATT 8 OHM ZONE - 3RD 3 WATT 70 VOLT ZONE
- ✿ 24 VOLT DC - 500 MA REGULATED AUXILIARY POWER SUPPLY
- ✿ MUSIC ON HOLD OUTPUT WITH INDEPENDENT LEVEL CONTROL
- ✿ AUTOMATIC LOAD MANAGEMENT SYSTEM
- ✿ THERMALLY ACTIVATED VARIABLE SPEED COOLING FAN
- ✿ BUILT-IN SURGE PROTECTION

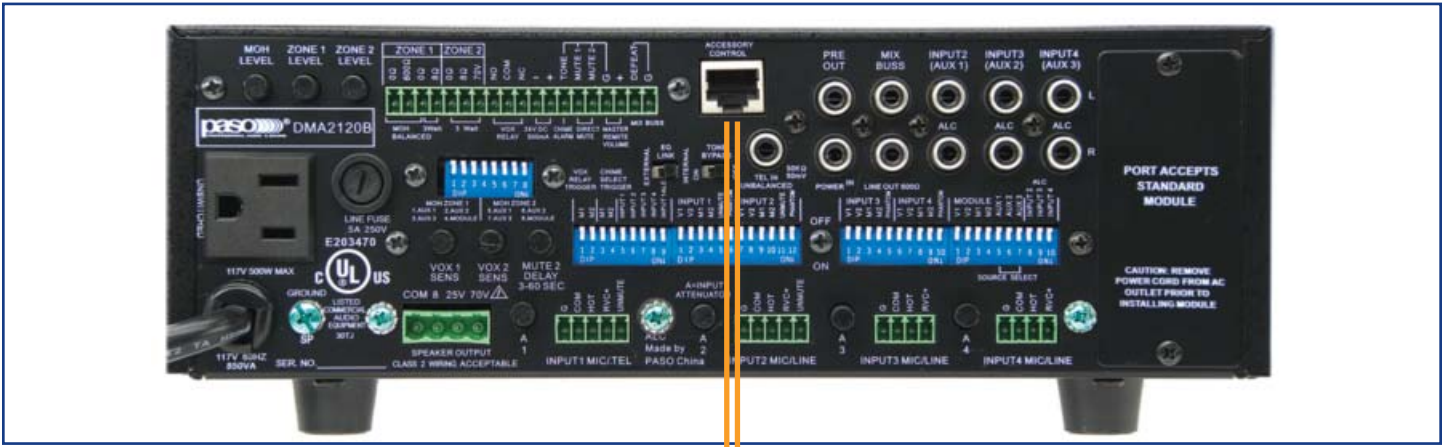

PRMS4 - CAT5 INPUT REMOTE CONTROLLER

PRMS4 - 4-Multi-Source Remote Controller with independent Level Control. Utilizes a CAT5 Socket and Phoenix Connector for connection to Amplifier. On-Off Switch and Level Control for each Input. Uses a 4" Square Backbox. White Plate.

Dimensions: 4.75"X4.75", 1.5" D.

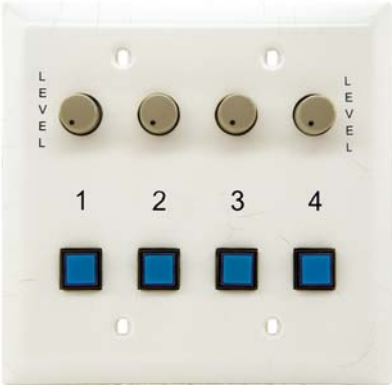

The optional Model PRMS4 Controller is a cost effective accessory providing On-Off and Output Level Control for each of the Amplifier 4 Inputs either independently or collectively using CAT5 cabling up to a distance of 1000 ft.. Each of the illuminated push-buttons 1-2-3-4 corresponds to the Amplifier Inputs 1-2-3-4. Labels and additional color lenses for the push-buttons are provided. NOTE: The controls of the PRMS4 do not alter the Output level set by the MOH - ZONE 1-ZONE 2 Controls.

ACCESSORIES



PM01ML - Microphone/Line Input Module - Amplifier Module for PASO Amplifiers. Mounts on rear panel port. Versatile Input Module provides balanced Microphone Input switchable to Line Input. Remote Volume Control capability

- Microphone Input: 250 Ohm Balanced • Sensitivity: 1.5 Mv • Line Input: 47 K unbalanced • Sensitivity: 100 Mv • Microphone/Line Switch: Slide Switch on PCB • MIC Input Phantom Power: 16 + 16 Volt (PCB Jumper) • MIC Low-Cut Filter: -10 dB at 100 Hz (PCB Jumper) • Output Level Control: Front Panel Screwdriver Adjust • Remote Volume Control MIC and Line: 10 K Pot • Terminations: MIC Input = Screw terminals, Remote Volume = Screw terminals, LINE/AUX = Dual RCA Jacks • Dimensions: 1.38" W., x 3" H. x 3" D. (35X78X78 mm) • Net Weight: 5 oz (0.15 Kg)

PML1X6 - Line Distribution Amplifier Module - Mounts on rear panel port. This is an extremely versatile Line Distribution Module providing one Line Input (L+R) and Six independent Mono Line Outputs. Ideally suited for Multi-Amplifier Installations and for Music Distribution Systems using one source for up to six Outputs.

- Input: 47 K unbalanced • Output: 47 K unbalanced • Gain: Unity • THD: Less than 0.03% at 1 Khz • Frequency Response: 20 - 20,000 hz EQ set flat • Signal to Noise Ratio: > -80 dB below +4 dBu • Terminations: Input and Output RCA Jack • Contacts: Internal PCB Contacts • Supply Voltage: 24 VDC, 25 mA internally derived from amplifier • Panel Finish: Black • Dimensions: 1.38" W., x 3" H. x 3" D. (35X78X78 mm) • Net Weight: 5 oz (0.15 Kg)



27/3500 - Standard 19" Rack Mounting Kit. Complete with hardware. Black Finish. 2 Units of Rack vertical space.

AC3 - Programmable Multi-Tone Chime Module, Internal Plug-in Card. Mounts on main printed circuit board of Amplifier. Provides eight Electronic Chime Tones and Westminster. DIP-Switch Programming and Output Level Trimmer. Tone is triggered each time the Mute terminals are closed.

PMEQ16B - Internal Plug-in EQ Module. Mounts on main printed circuit board of Amplifier. Provides equalization for the BOSE® System 16 Speaker System.

PMEQ32B - Internal Plug-in EQ Module. Mounts on main printed circuit board of Amplifier. Provides equalization for the BOSE® System 32 Speaker System.

RVC10W - Remote Volume Control for Amplifiers. Decora Style Plate mounts on standard single Gang Box. Complete with mounting hardware. Control Potentiometer: 10 K Ohm • Termination: 4" Pigtail, stripped and tinned • Dimensions: 4.5" H, 2.75" W, 0.6" Behind Front Plate. (115X70X16 mm) • Net Weight: 3 oz (0.088 Kg)



7 INPUT CHANNEL - PROFESSIONAL INTEGRATED AMPLIFIERS

Absolute Reliability - The DMS B SERIES is like no other Amplifier Line. Every component utilized is Heavy-Duty. Built tough to take the daily punishment required for continuous operation. DMS B delivers Outstanding Sonic Performance at any level of rated power and with any Speaker System Load. Breakthrough Technology is applied to every critical Circuitry from Power Surge Protection and Speed Controlled Fans for Thermal Protection to massive High Current Power Supplies. The Load Management System has the ability to adapt the power transfer to specific speaker loads. By delivering more current on demand to the Output Stages when Peak Power is needed the Amplifier will automatically provide the additional Reserve Headroom required. Sound purity is maintained with lower distortion for "Heavier Bass" and "Clearer Highs". Four models are available from 40 Watt to 260 Watt in only 2U of Rack space.

MODELS

DMS3040B - 40 W INTEGRATED AMPLIFIER

DMS3080B - 80 W INTEGRATED AMPLIFIER

DMS3120B - 120 W INTEGRATED AMPLIFIER

DMS3260B - 260 W INTEGRATED AMPLIFIER

CONVERTIBLE INPUTS - PHOENIX CONNECTORS - REAR PANEL PROGRAMMING

- ❁ HIGH PERFORMANCE MULTI MEDIA INTEGRATED AMPLIFIERS
- ❁ PHOENIX CONNECTORS
- ❁ DIP SWITCH REAR PANEL PROGRAMMABLE
- ❁ SEVEN CHANNEL FULLY ADDRESSABLE INPUTS
- ❁ FOUR AUX INPUTS - RCA CONNECTORS
- ❁ 600 OHM TRANSFORMER BALANCED PHONE PAGING INPUT
- ❁ ALL CHANNEL REMOTE VOLUME CONTROL CAPABILITY
- ❁ MASTER REMOTE VOLUME CONTROL
- ❁ ALL CHANNEL INPUT SENSITIVITY CONTROL
- ❁ PORT FOR INPUT/OUTPUT AUDIO MODULES
- ❁ BUILT-IN ROOM COMBINING SYSTEM
- ❁ BUILT-IN ZONE PAGING SYSTEM
- ❁ BUILT-IN ADDRESSABLE AUTO VOX RELAY
- ❁ AUTOMATIC LEVEL CONTROL/COMPRESSORS ON AUX 3 AND 4
- ❁ WIDE POWER BANDWIDTH AND VERY LOW DISTORTION
- ❁ 2ND 5 WATT 8 OHM ZONE - 3RD 5 WATT 70 VOLT ZONE
- ❁ 24 VOLT DC - 500 MA REGULATED AUXILIARY POWER SUPPLY
- ❁ MUSIC ON HOLD OUTPUT WITH INDEPENDENT LEVEL CONTROL
- ❁ AUTOMATIC LOAD MANAGEMENT SYSTEM
- ❁ THERMALLY ACTIVATED VARIABLE SPEED COOLING FAN
- ❁ ON - OFF POWER REMOTE RELAY CAPABILITY
- ❁ BUILT-IN SURGE PROTECTION





EXCEPTIONAL PERFORMANCE - PROVEN INSTALLED RELIABILITY



POWER OUTPUT

DMS3040B 40 Watt RMS
DMS3080B 80 Watt RMS
DMS3120B 120 Watt RMS
DMS3260B 260 Watt RMS
Distortion: Less than 0.03% THD
Frequency Response: 20 - 20,000 Hz \pm 1 db

INPUTS

Input 1 MIC or LINE BAL
Input 2 MIC or AUX 1
Input 3 MIC or AUX 2
Input 4 MIC or AUX 3
Input 5 MIC or AUX 4

Input 6 MIC or TELPAGE
Input 7 Module Port
RVC: Remote Volume on all Inputs
Phantom Power: On all Inputs via DIP Switch
Module Port: Accepts Standard Module
EQ LINK: Pre out, Power Amp in w/Switch
Line Output: Line Out 600 ohm - 1.5 V loaded
MIX BUSS: IN/OUT with remote Control
Defeat Relay
MOH Output: 600 ohm-1 Volt Xfmr Balanced
Zone 2 Output: 5 W-8 ohm with Control
Zone 3 Output: 5 W-8 ohm/70 Volt with Control
Main Output Z: 8 ohm, 25 Volt and 70 Volt line

Terminations: Phoneix Connectors, RCA Jacks
Programming: Rear Panel DIP Switches
Housing Finish: Black

DIMENSIONS:

17" W., 15" D., 4" H. w/feet (432X380X102 mm)
 3.5" H (89 mm). less feet

NET WEIGHT

DMS3040B 8 Lbs (8.2 Kg)
DMS3080B 21 Lbs (9.6 Kg)
DMS3120B 23 Lbs (11 Kg)
DMS3260B 34 Lbs (15.5 Kg)

ACCESSORIES



PM01ML - Microphone/Line Input Module - Amplifier Module for PASO Amplifiers. Mounts on rear panel port. Versatile Input Module provides balanced Microphone Input switchable to Line Input. Remote Volume Control capability

- Microphone Input: 250 Ohm Balanced • Sensitivity: 1.5 Mv • Line Input: 47 K unbalanced • Sensitivity: 100 Mv • Microphone/Line Switch: Slide Switch on PCB • MIC Input Phantom Power: 16 + 16 Volt (PCB Jumper) • MIC Low-Cut Filter: -10 dB at 100 Hz (PCB Jumper) • Output Level Control: Front Panel Screwdriver Adjust • Remote Volume Control MIC and Line: 10 K Pot • Terminations: MIC Input = Screw terminals, Remote Volume = Screw terminals, LINE/AUX = Dual RCA Jacks • Dimensions: 1.38" W., x 3" H. x 3" D. (35X78X78 mm) • Net Weight: 5 oz (0.15 Kg)

PML1X6 - Line Distribution Amplifier Module - Mounts on rear panel port. This is an extremely versatile Line Distribution Module providing one Line Input (L+R) and Six independent Mono Line Outputs. Ideally suited for Multi-Amplifier Installations and for Music Distribution Systems using one source for up to six Outputs.

- Input: 47 K unbalanced • Output: 47 K unbalanced • Gain: Unity • THD: Less than 0.03% at 1 Khz • Frequency Response: 20 - 20,000 hz EQ set flat • Signal to Noise Ratio: > -80 dB below +4 dBu • Terminations: Input and Output RCA Jack • Contacts: Internal PCB Contacts • Supply Voltage: 24 VDC, 25 mA internally derived from amplifier • Panel Finish: Black • Dimensions: 1.38" W., x 3" H. x 3" D. (35X78X78 mm) • Net Weight: 5 oz (0.15 Kg)



27/3501 - Standard 19" Rack Mounting Kit. Complete with hardware. Black Finish. 2 Units of Rack vertical space.



AC3 - Programmable Multi-Tone Chime Module, Internal Plug-in Card. Mounts on main printed circuit board of Amplifier. Provides eight Electronic Chime Tones and Westminster. DIP-Switch Programming and Output Level Trimmer. Tone is triggered each time the Mute terminals are closed.



PMEQ16B - Internal Plug-in EQ Module. Mounts on main printed circuit board of Amplifier. Provides equalization for the BOSE® System 16 Speaker System.

PMEQ32B - Internal Plug-in EQ Module. Mounts on main printed circuit board of Amplifier. Provides equalization for the BOSE® System 32 Speaker System.



RVC10W - Remote Volume Control for Amplifiers. Decora Style Plate mounts on standard single Gang Box. Complete with mounting hardware. Control Potentiometer: 10 K Ohm • Termination: 4" Pigtail, stripped and tinned • Dimensions: 4.5" H, 2.75" W, 0.6" Behind Front Plate. (115X70X16 mm) • Net Weight: 3 oz (0.088 Kg)

IO INPUT CHANNEL - PROFESSIONAL MIXER AND INTEGRATED AMPLIFIERS

Absolute Performance - The DMS PLUS SERIES is like no other Amplifier Line. Every component utilized is Heavy-Duty. Built tough to take the daily punishment required for continuous operation. DMS PLUS delivers Outstanding Sonic Performance at any level of rated power and with any Speaker System Load. Breakthrough Technology is applied to every critical Circuitry from Power Surge Protection and Speed Controlled Fans for Thermal Protection to massive High Current Power Supplies. The Load Management System has the ability to adapt the power transfer to specific speaker loads. By delivering more current on demand to the Output Stages when Peak Power is needed the Amplifier will automatically provide the additional Reserve Headroom required. Digital Coax Inputs and Outputs are provided for outstanding sound purity with lower distortion for "Heavier Bass" and "Clearer Highs". Two models are available from 260 Watt to 360 Watt plus a Preamplifier Mixer in only 2U of Rack space.

MODELS

DMS10X - 10 CHANNEL PREAMPLIFIER MIXER
DMS260P - 260 W INTEGRATED AMPLIFIER

DMS360P - 360 W INTEGRATED AMPLIFIER

CONVERTIBLE INPUTS - PHOENIX CONNECTORS - REAR PANEL PROGRAMMING

- ❁ HIGH PERFORMANCE MULTI MEDIA INTEGRATED AMPLIFIERS
- ❁ 10 CHANNEL FULLY ADDRESSABLE INPUTS
- ❁ PHOENIX CONNECTORS - REAR PANEL PROGRAMMABLE
- ❁ ANALOG TO DIGITAL AND DIGITAL TO ANALOG CONVERTERS
- ❁ DUAL COAX DIGITAL INPUTS AND COAX AUX DIGITAL OUTPUT
- ❁ 600 OHM TRANSFORMER BALANCED PHONE PAGING INPUT
- ❁ ALL CHANNEL REMOTE VOLUME CONTROL CAPABILITY
- ❁ ALL CHANNEL INPUT SENSITIVITY CONTROL
- ❁ PORT FOR INPUT/OUTPUT AUDIO MODULES
- ❁ BUILT-IN REMOTE CONTROL ROOM COMBINING SYSTEM
- ❁ BUILT-IN AUTOMATIC ROOM LEVEL CONTROLLER
- ❁ BUILT-IN ZONE PAGING SYSTEM
- ❁ AUTOMATIC LEVEL CONTROL/COMPRESSORS ON AUX 3 AND 4
- ❁ WIDE POWER BANDWIDTH AND VERY LOW DISTORTION
- ❁ 2ND 5 WATT 8 OHM ZONE - 3RD 15 WATT 70 VOLT ZONE
- ❁ MUSIC ON HOLD OUTPUT WITH INDEPENDENT LEVEL CONTROL
- ❁ AUTOMATIC LOAD MANAGEMENT SYSTEM
- ❁ THERMALLY ACTIVATED VARIABLE SPEED COOLING FAN
- ❁ ON - OFF POWER REMOTE RELAY CAPABILITY
- ❁ BUILT-IN SURGE PROTECTION





DMSIOX - 10 CHANNEL PREAMPLIFIER MIXER - DIGITAL COAX INPUTS/OUTPUTS

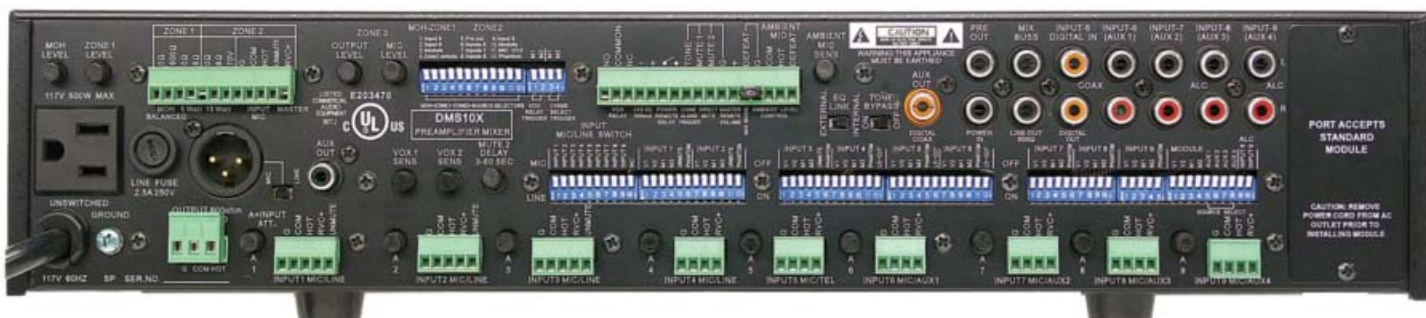

ACCESSORIES



PM01ML - Microphone/Line Input Module - Amplifier Module for PASO Amplifiers. Mounts on rear panel port. Versatile Input Module provides balanced Microphone Input switchable to Line Input. Remote Volume Control capability

- Microphone Input: 250 Ohm Balanced • Sensitivity: 1.5 Mv • Line Input: 47 K unbalanced • Sensitivity: 100 Mv • Microphone/Line Switch: Slide Switch on PCB • MIC Input Phantom Power: 16 + 16 Volt (PCB Jumper) • MIC Low-Cut Filter: -10 dB at 100 Hz (PCB Jumper) • Output Level Control: Front Panel Screwdriver Adjust • Remote Volume Control MIC and Line: 10 K Pot • Terminations: MIC Input = Screw terminals, LINE/AUX = Dual RCA Jacks • Dimensions: 1.38" W. x 3" H. x 3" D. (35X78X78 mm) • Net Weight: 5 oz (0.15 Kg)

PML1X6 - Line Distribution Amplifier Module - Mounts on rear panel port. This is an extremely versatile Line Distribution Module providing one Line Input (L+R) and Six independent Mono Line Outputs. Ideally suited for Multi-Amplifier Installations and for Music Distribution Systems using one source for up to six Outputs.

- Input: 47 K unbalanced • Output: 47 K unbalanced • Gain: Unity • THD: Less than 0.03% at 1 KHz • Frequency Response: 20 - 20,000 Hz EQ set flat • Signal to Noise Ratio: > -80 dB below +4 dBu • Terminations: Input and Output RCA Jack • Contacts: Internal PCB Contacts • Supply Voltage: 24 VDC, 25 mA internally derived from amplifier • Panel Finish: Black • Dimensions: 1.38" W. x 3" H. x 3" D. (35X78X78 mm) • Net Weight: 5 oz (0.15 Kg)



27/3501 - Standard 19" Rack Mounting Kit. Complete with hardware. Black Finish. 2 Units of Rack vertical space.



AC3 - Programmable Multi-Tone Chime Module, Internal Plug-in Card. Mounts on main printed circuit board of Amplifier. Provides eight Electronic Chime Tones and Westminster. DIP-Switch Programming and Output Level Trimmer. Tone is triggered each time the Mute terminals are closed.



PMEQ16B - Internal Plug-in EQ Module. Mounts on main printed circuit board of Amplifier. Provides equalization for the BOSE® System 16 Speaker System.

PMEQ32B - Internal Plug-in EQ Module. Mounts on main printed circuit board of Amplifier. Provides equalization for the BOSE® System 32 Speaker System.



RVC10W - Remote Volume Control for Amplifiers. Decora Style Plate mounts on standard single Gang Box. Complete with mounting hardware. Control Potentiometer: 10 K Ohm • Termination: 4" Pigtail, stripped and tinned • Dimensions: 4.5" H, 2.75" W, 0.6" Behind Front Plate. (115X70X16 mm) • Net Weight: 3 oz (0.088 Kg)

4 INPUT CHANNEL - INTEGRATED POWER AMPLIFIERS

M O D E L - DMS4361B - 360 Watt Power Amplifier



- | | |
|-----------------------------------------------------------------------------------------------------------------------------------------------------------------------------------------------------------------------------------------------------------------------------------------------------------------------------------------------------------------------------------------------------------------------------------------------------------------------------------------------------------------------------------------------------------------------------------------------------------------------------------------------------------------------------------------------------------------------------------------------------------------------------------------------------------------------------------------------------------------------------------------------------------------------------------------------------------------------------------------------------------|-------------------------------------------------------------------------------------------------------------------------------------------------------------------------------------------------------------------------------------------------------------------------------------------------------------------------------------------------------------------------------------------------------------------------------------------------------------------------------------------------------------------------------------------------------------------------------------------------------------------------------------------------------------------------------------------------------------------------------------------------------------------------------------------------------------------------------------------------------------------------------------------------------------------------------------------------------------------------------------------------------------------------------------|
| <ul style="list-style-type: none"> <input type="checkbox"/> High Performance High Reliability Design <input type="checkbox"/> Wide Frequency Response - Very Low Distortion <input type="checkbox"/> 4 Channel Inputs - 3 Zone Outputs <input type="checkbox"/> Balanced Microphone Input <input type="checkbox"/> Phantom Power on MIC Input with Selector <input type="checkbox"/> Telephone Paging Input <input type="checkbox"/> Telephone Input Level Control <input type="checkbox"/> Auxiliary Input With Stereo Summing <input type="checkbox"/> Auxiliary Input Attenuator <input type="checkbox"/> Independent Input Controls <input type="checkbox"/> Addressable VOX - Voice Activated Muting <input type="checkbox"/> VOX Variable Time Delay Function <input type="checkbox"/> Addressable MUTE Buss <input type="checkbox"/> Direct Muting or Unmuting | <ul style="list-style-type: none"> <input type="checkbox"/> Rear Panel Port Accepts Standard Module <input type="checkbox"/> External EQ Link <input type="checkbox"/> 600 ohm and 8 ohm 1 Watt - Music on Hold Amplifier <input type="checkbox"/> MOH Amplifier Source Selector <input type="checkbox"/> Zone 2-3, 1 W 8 ohm Output - Independent Control <input type="checkbox"/> MIX Buss and 600 ohm Line Output <input type="checkbox"/> NO/NC VOX Operated Relay <input type="checkbox"/> AUX1 and Master Remote Volume Controls <input type="checkbox"/> 24 V DC 250 mA Regulated Power Supply Output <input type="checkbox"/> 8 ohm, 25 Volt & 70 Volt Output <input type="checkbox"/> Pre-EQ Subwoofer Output <input type="checkbox"/> Post-EQ Subwoofer Output <input type="checkbox"/> 19" Rack Mounting Ready <input type="checkbox"/> Low profile - 2-U of Vertical Rack space |
|-----------------------------------------------------------------------------------------------------------------------------------------------------------------------------------------------------------------------------------------------------------------------------------------------------------------------------------------------------------------------------------------------------------------------------------------------------------------------------------------------------------------------------------------------------------------------------------------------------------------------------------------------------------------------------------------------------------------------------------------------------------------------------------------------------------------------------------------------------------------------------------------------------------------------------------------------------------------------------------------------------------|-------------------------------------------------------------------------------------------------------------------------------------------------------------------------------------------------------------------------------------------------------------------------------------------------------------------------------------------------------------------------------------------------------------------------------------------------------------------------------------------------------------------------------------------------------------------------------------------------------------------------------------------------------------------------------------------------------------------------------------------------------------------------------------------------------------------------------------------------------------------------------------------------------------------------------------------------------------------------------------------------------------------------------------|

**Rack Mounting
with 27/3501 KIT**

5 INPUT CHANNEL - DIGITAL INTEGRATED POWER AMPLIFIERS

MODEL - DX5480P - 480 Watt Power Amplifier

**Rack Mounting
with 27/3501 KIT**

- ❁ HIGH PERFORMANCE MULTIMEDIA DIGITAL POWER AMPLIFIERS
- ❁ 5 CHANNEL FULLY ADDRESSABLE INPUTS
- ❁ PHOENIX CONNECTORS - REAR PANEL PROGRAMMABLE
- ❁ ANALOG TO DIGITAL AND DIGITAL TO ANALOG CONVERTERS
- ❁ COAX DIGITAL INPUT AND COAX DIGITAL OUTPUT
- ❁ 600 OHM TRANSFORMER BALANCED PHONE PAGING INPUT
- ❁ ALL CHANNEL REMOTE VOLUME CONTROL CAPABILITY
- ❁ ALL CHANNEL INPUT SENSITIVITY CONTROL
- ❁ ALL INPUTS SOURCE SELECTOR WITH CAT 5 CABLING
- ❁ PORT FOR INPUT/OUTPUT AUDIO MODULES
- ❁ BUILT-IN VOX ACTIVATED RELAY WITH NO AND NC CONTACTS
- ❁ 4 HIGH PASS FILTERS 30 - 60 - 80 - 120 HZ
- ❁ BUILT-IN ZONE PAGING SYSTEM
- ❁ AUTOMATIC LEVEL CONTROL/COMPRESSORS ON ALL INPUTS
- ❁ WIDE POWER BANDWIDTH AND VERY LOW DISTORTION
- ❁ 2ND 5 WATT 8 OHM ZONE - 3RD 15 WATT 8 OHM AND 70 VOLT ZONE
- ❁ MUSIC ON HOLD OUTPUT WITH INDEPENDENT LEVEL CONTROL
- ❁ AUTOMATIC LOAD MANAGEMENT SYSTEM
- ❁ THERMALLY ACTIVATED VARIABLE SPEED COOLING FAN
- ❁ ON - OFF POWER REMOTE RELAY CAPABILITY
- ❁ BUILT-IN SURGE - OVER CURRENT AND OVERLOAD PROTECTION
- ❁ FRONT PANEL MASTER VOLUME CONTROL WITH BY-PASS SWITCH

See Specifications for PRMS4 - CAT5 Controller on page 15

**CONVERTIBLE INPUTS - PHOENIX CONNECTORS - REAR PANEL PROGRAMMING
DIGITAL COAX INPUT/OUTPUT - CAT 5 INPUTS CONTROLLER - 2ND 15 WATT ZONE**



OPTIONAL MODULES FOR AMPLIFIERS

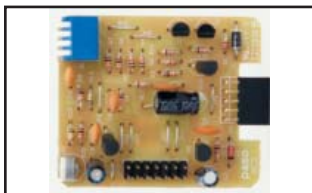

AC3 - Multi-Tone Chime Card

Programmable Multi-Tone Chime Module, Internal Plug-in Card. Mounts on main printed circuit board of Amplifier. Provides eight Electronic Chime Tones and Westminster. DIP-Switch Programming and Output Level Trimmer. Tone is triggered each time the Mute terminals are closed.



PM03W - 3-Watt 4 Ohm and 70 V Amplifier Module - Amplifier Module for DMS Series Amplifiers.

Mounts on rear panel port. This is an extremely versatile output module that provides a fourth and independent 3 Watt output Zone. Internal Source Switch (3 position) allows to select the source from Input 2 or 3 (internal connection) of the Amplifier or a separate source by using the Module Line Input. Power is derived internally from the Amplifier. 4 ohm and 70 Volt line output are provided.

• **Power Output:** 3 Watt RMS • **Frequency Response:** 40 - 18 KHz • **Output Impedance:** 4 ohm, 70 Volt line • **Input Impedance:** 47K ohm • **Sensitivity:** 200 Mv • **Panel Control:** Output Level (screwdriver adjust) • **Internal Source Selector:** Input2 , Input 3, External Input • **Terminations:** Line Input = RCA Jack, Output = Screw terminals • **Supply Voltage:** 24 V DC (derived from amplifier) • **Finish:** Black • **Dimensions:** 1.38" W., x 3" H. x 3" D.



M3EQ - 3-Band Audio Equalizer Module - Audio Equalizer Standard Module for DMS Series Amplifiers.

Mounts on rear panel port. This is an extremely versatile equalizer module providing three independent EQ adjustments for Low, Mid and High audio spectrum ranges. Standard Input and Output jacks permit connection through the EQ Link circuit of the Amplifier. Each of the three band controls are detented for positive center positioning (no EQ). Power is derived internally from the Amplifier.

• **Input:** 47 K unbalanced • **Output:** 47 K unbalanced • **Gain:** Unity THD: Less than 0.030% at 1 KHz • **Frequency Response:** 20 - 20,000 hz EQ set flat • **Signal to Noise Ratio:** < -80 dB below +4 dBu • **Equalization:** Low Band: ± 12 dB at 100 Hz Mid Band: ± 12 dB at 1 KHz High Band: ± 12 dB at 10 KHz • **Controls:** Zero Detented • **Terminations:** Input and Output RCA Jack • **Contacts:** Internal PCB Contacts • **Supply Voltage:** 24 VDC, 25 mA internally derived from amplifier • **Panel Finish:** Black • **Dimensions:** 1.38" W., x 3" H. x 3" D. (35X78X78 mm) • **Cable Supplied:** 12" Dual RCA Cable with Male Plugs on both ends. • **Net Weight:** 5 oz (0.15 Kg)



PM01ML - Microphone/Line Input Module - Amplifier Module for DMS Series Amplifiers. Mounts on rear panel port. Versatile Input Module provides balanced Microphone Input switchable to Line Input. Remote Volume Control capability

• **Microphone Input:** 250 Ohm Balanced • **Sensitivity:** 1.5 Mv • **Line Input:** 47 K unbalanced • **Sensitivity:** 100 Mv • **Microphone/Line Switch:** Slide Switch on PCB • **MIC Input Phantom Power:** 16 + 16 Volt (PCB Jumper) • **MIC Low-Cut Filter:** -10 dB at 100 Hz (PCB Jumper) • **Output Level Control:** Front Panel Screwdriver Adjust • **Remote Volume Control MIC and Line:** 10 K Pot • **Terminations:** MIC Input = Screw terminals, Remote Volume = Screw terminals, LINE/AUX = Dual RCA Jacks • **Dimensions:** 1.38" W., x 3" H. x 3" D. (35X78X78 mm) • **Net Weight:** 5 oz (0.15 Kg)



PML1X6 - Line Distribution Amplifier Module - Mounts on rear panel port. This is an extremely versatile Line Distribution module providing one Line Input (L+R) and Six independent Mono Line Outputs. Ideally suited for Multi-Amplifier Installations and for Music Distribution Systems using one source for up to six Outputs.

• **Input:** 47 K unbalanced • **Output:** 47 K unbalanced • **Gain:** Unity • **THD:** Less than 0.03% at 1 KHz • **Frequency Response:** 20 - 20,000 hz EQ set flat • **Signal to Noise Ratio:** > -80 dB below +4 dBu • **Terminations:** Input and Output RCA Jack • **Contacts:** Internal PCB Contacts • **Supply Voltage:** 24 VDC, 25 mA internally derived from amplifier • **Panel Finish:** Black • **Dimensions:** 1.38" W., x 3" H. x 3" D. (35X78X78 mm) • **Net Weight:** 5 oz (0.15 Kg)

P4035 - RACK MOUNTING SHELF - 2 AND 3 RACK UNITS

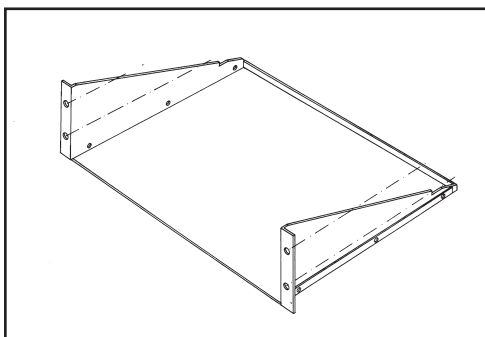

P 4035/2B 2 Units

P4035/2B RACK MOUNTING SHELF 2U

19" Utility Rack Mounting Shelf. Heavy-Duty Steel Construction. Occupies 2 Units of Vertical Rack Space (3.1/2"). • Construction: Heavy-Duty Steel • Finish: Matte Black • Dimensions: 19" W., 3 1/2" H., 14 3/4" D. (482 x 89 x 375 mm) • Net Weight: 4 Lb (1.8 Kg)

P 4035B 3 Units

P4035B RACK MOUNTING SHELF 3U

19" Utility Rack Mounting Shelf. Heavy-Duty Steel Construction. Occupies 3 Units of Vertical Rack Space (5.1/4"). • Construction: Heavy-Duty Steel • Finish: Matte Black • Dimensions: 19" W., 5 1/4" H., 14 3/4" D. (482 x 134 x 375 mm) • Net Weight: 5 Lb (2.3 Kg)

PRMS4 - CAT5 - 4 INPUT REMOTE CONTROLLER

PRMS4 - CAT5 INPUT REMOTE CONTROLLER

PRMS4 - 4-Multi-Source Remote Controller with independent Level Control. Utilizes a CAT5 Socket and Phoenix Connector for connection to Amplifier. On-Off Switch and Level Control for each Input. Uses a 4" Square Backbox. White Plate.

Dimensions: 4.75"X4.75", 1.5" D.

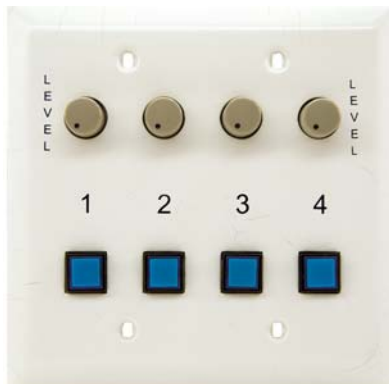

The optional Model PRMS4 Controller is a cost effective accessory providing On-Off and Output Level Control for each of the Amplifier 4 Inputs either independently or collectively using CAT5 cabling up to a distance of 1000 ft.. Each of the illuminated push-buttons 1-2-3-4 corresponds to the Amplifier Inputs 1-2-3-4. Labels and additional color lenses for the push-buttons are provided. NOTE: The controls of the PRMS4 do not alter the Output level set by the MOH - ZONE 1-ZONE 2 Controls. May be used with the PASO Series DMAB and DXP Series.

PGR12 - DUAL CHANNEL 6 WATT + 6 WATT UTILITY AMPLIFIER AND CONTROLLER



PGR12 - 12 Watt Utility Digital Amplifier ideally suited for Overhead Projector Audio Amplifier and other applications requiring a small size utility Amplifier. Dual Audio Output 6+6 Watt. Three built-in Relay Switching Contacts, voice activated and direct trigger. Automatic switching between external and internal speakers. Independent Remote Volume Control for Channel A & B via a PASO Model RVC10W wall mount Remote Volume Control. May be Wall, Ceiling or Shelf mounted. Phoenix Connectors. Switching Power Supply. MAY BE USED TO POWER SMALL AREAS WITH PAGING, MUSIC, DOOR ALARMS, CLASS ROOMS PA, PROJECTORS, ETC.

Dual Power Output: Channel A = 6 Watt RMS - Channel B = 6 Watt RMS. **Frequency Response:** 30 - 20,000 Hz. **Output Impedance:** 4 - 8 ohm. **Input Impedance:** 47K ohm. **Sensitivity:** 200 Mv. **Panel Controls:** Input Attenuator, Vox Sensitivity, Channel A Output level, Channel B Output level. **Remote Volume Controls:** Channel A - B with 10K Pot. **Auto Vox Relay:** Dual NO/NC Contacts, VOX Activated. **Relay Contacts Rating:** 30 VDC - 7 A. **Terminations:** Line Input/Output= RCA Jack, other = Phoenix Connector. **Supply Voltage:** 12 VDC - 2 A with external Power Supply. **Dimensions:** 5.1" W., x 1.75" H. x 3.75" D. (127X45X96mm). **Net Weight:** 10 oz (0.3 Kg). **Black**

- ❑ Dual Amplifiers 6 Watt + 6 Watt
- ❑ Automatic Speaker switching
- ❑ VOX Activated Operation
- ❑ Recessed Output Level Controls
- ❑ Remote Output Level Controls
- for Channel A and B
- ❑ External Line Input
- ❑ External Line Output
- ❑ Wide Frequency Response
- ❑ Dual VOX Relay Contacts NO/NC
- ❑ 4 - 8 ohm Outputs
- ❑ Input for Greeter Box Audio
- ❑ VOX Sensitivity Control
- ❑ Phoenix Connectors
- ❑ External Switching Power
- Supply provided
- ❑ FCC - CSA - UL Listed

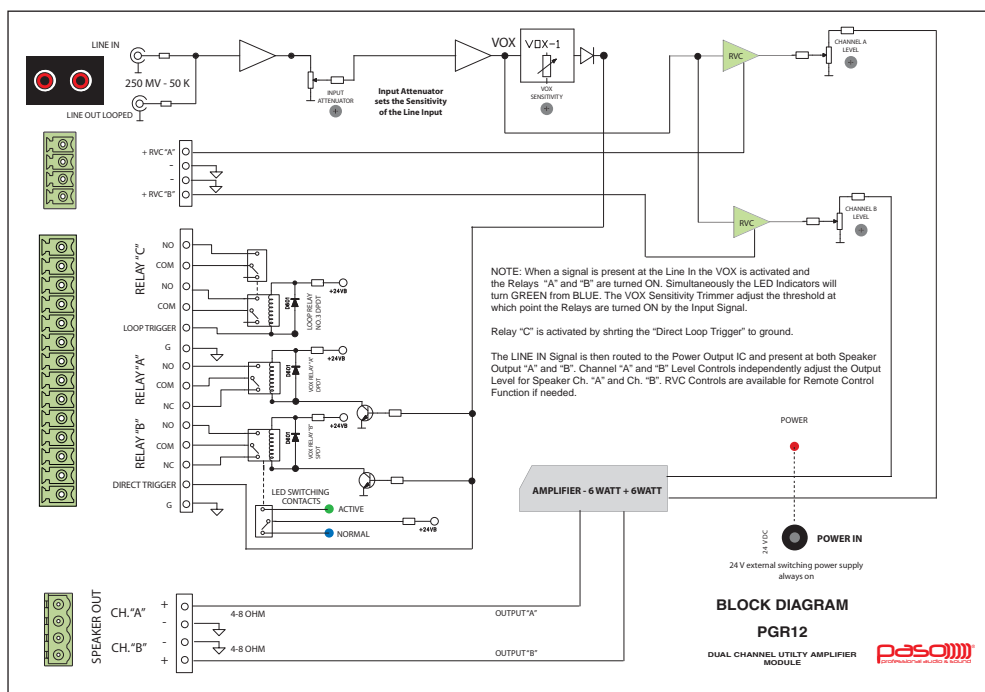

100 Channel UHF True Diversity IrDA INFRARED SYNC Wireless System

MODELS

RDU2500/MW593 - 100 CHANNEL UHF SYSTEM WITH BELT PACK TRANSMITTER
RDU2500/MW595 - 100 CHANNEL UHF SYSTEM WITH HAND-HELD TRANSMITTER

RDU2500 RECEIVER

- UHF PLL Synthesized 100 Channels selectable
- True Diversity System for highest quality reception with no dropouts
- LCD Display Menu assisted digital operation
- Menu driven Frequency, Channel, Squelch and Output Level functions
- Microprocessor Control RF Technology for greater operating range
- AUTOSCAN function simplifies multi-channel setup
- Low Battery indicator on the Receiver monitors Transmitter Battery status
- Digital Output Level Control for precision setting and low noise
- XLR Male Balanced and 1/4" Jack Unbalanced outputs
- Automatic bidirectional channel SYNC with Transmitters
- SCAN Function automatically searches for cleanest channel
- AF, RF LED bar indicators and Diversity A/B indicators
- One Half 19" Enclosure
- Rack mount for single or dual Rcvr with Optional Rack Kit (1U)
- Antennas can be either rear or front mount (with optional kit)

**100 Channel UHF - IrDA
 True Diversity Wireless System**
Frequency Agile - Extended Range
Dual Front End - Digitally Synthesized
Bidirectional IrDA Infrared Channel Sync



**100 CHANNEL
 OPTIONAL MW593
 IrDA
 PENDANT/BELTPACK
 TRANSMITTER**
 Infrared Automatic
 Transmitter Sync

**100 Channel
 OPTIONAL MW595
 IrDA
 HAND-HELD
 TRANSMITTER**
 Rugged Construction
 Reliable Performance
 Infrared Automatic
 Transmitter Sync

FOR ADDITIONAL ACCESSORIES, ANTENNAS, ETC. SEE PAGE 26

Bidirectional IrDA Channel Sync between Receiver and Transmitters

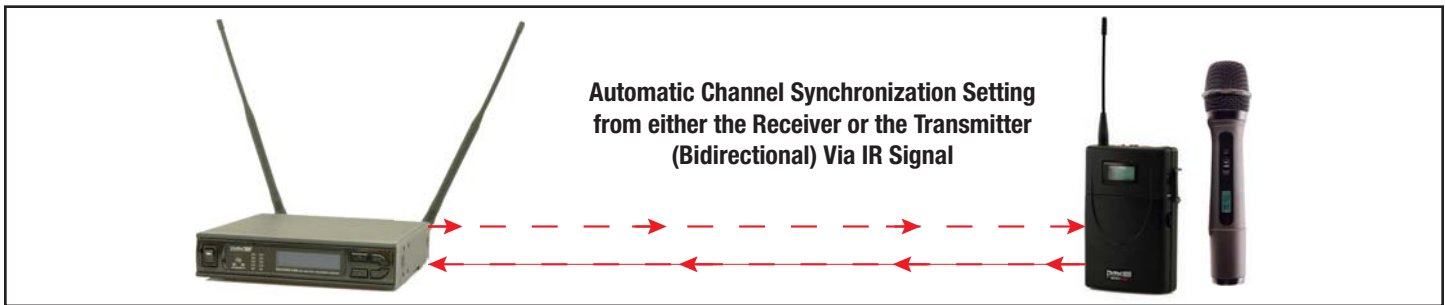

Microprocessor Controlled Antenna Diversity vs. True Diversity

The heart of an Antenna Diversity system is the Microprocessor that constantly processes and analyzes the signal strength received from the two antennas. When it detects that the signal is becoming weak and dropout is imminent, it forces the Receiver to switch over to the other antenna to avoid "dropout" as the signal strengths from two antennas are never the same. In a True Diversity System two sets of identical RF Front End and IF circuits coexist. The Diversity Comparator electronics constantly compares the two signal strengths and switches between the two received signals depending on which is stronger thus efficiently eliminating dropout due to a weak signal. Technically speaking a Microprocessor Controlled Antenna Diversity System performs better than a non-Diversity system and are suitable for many PA applications which are budget conscious, however, for Broadcast, Concert and best performance applications, the True Diversity is the only solution.

AUTOSCAN Function

The Autoscan Function automatically searches for the next clean channel simplifying a multi-channel application set-up.



**RDU2500
REAR PANEL VIEW**

RDU2500 - SINGLE AND DUAL RACK MOUNT KITS

**PRK251
19" (IU) SINGLE
RECEIVER
RACK MOUNT
KIT**



**PRK252
19" (IU) DUAL RECEIVER
(side by side)
RACK MOUNT
KIT**



ANT250 - DUAL ANTENNA FRONT MOUNTING FOR RACK KIT PRK251 - INCLUDES PRE-WIRED CABLES AND CONNECTORS

ANT253 - DUAL ANTENNA FRONT MOUNTING FOR RACK KIT PRK252 - INCLUDES PRE-WIRED CABLES, CONNECTORS AND ANTENNAS MIXER BOARD

RDU2500 - 100 CHANNEL UHF FREQUENCY AGILE IrDA SYNC DIVERSITY RECEIVER

Carrier Frequency Range: 654.00 Mhz - 678.975 MHz - Frequency Group: 10 Receivers per installation - RF Generation: Microprocessor PLL Synthesized - Peak Deviation: ± 40 KHz - Frequency Stability: $\pm 0.005\%$ - S/N Ratio: >110 dB - Sensitivity: -100 dBm - Image rejection: >85 dB - Dynamic Range: Super High Dynamic >110 dB - Channel Selector: Multifunction LCD Display - Audio Output: Unbalanced (1/4" Jack) + 4 dBm (1.25 V) 5 KHz, Balanced (XLR) + 10 dBm (2.5 V) 600 ohm - Output terminations: Phono 1/4" Jack and XLR Male - Antenna Socket: TNC Female - Rack Mount: see above examples - Panel Color Finish: Matte Black - Dimensions: 8" W, 8.75" D., 1.75" H. (200 mm X 220 mm X 44 mm) - Net Weight: 2.4 Lb (1.09 Kg). Complete with Switching Power Supply: 100-240 VAC, 50-60 Hz, 55-80 VA. Supplied with two UHF Antennas.

MW593 - 100 CHANNEL UHF IrDA SYNC PENDANT/BELTPACK TRANSMITTER

Complete with Electret Microphone, Wind Screen and Tie Clip - MIC Input Termination: 4-pin XLR Mini Connector - Multifunction LCD Display - Channel Selector: Digital on Display - Power Switch with Auto turn-off - Audio ON/OFF Mute Switch with LED Indicator - Battery Type: 2 X 1.5 V AA - Battery Life: 4-6 Hours (time may vary upon use) - UHF Frequency: 625 Mhz Band - Color Finish: Matte Black - Dimensions: 3.75" H. (7.5" including Antenna), 2.5" W., 1.2" D. (including Belt Clip). (95 mm (191 mm with antenna) X 65 mm X 31 mm) - Net Weight: 3 Oz. (76 grams). Batteries not included.

MW595 - 100 CHANNEL UHF IrDA SYNC HANDHELD TRANSMITTER

Microphone: Unidirectional Dynamic - Low Handling Noise - Multifunction LCD Display - Channel Selector: Digital on Display - Power Switch with Auto turn-off - Momentary ON LED Indicator - Battery Type: 2 X 1.5 V AA - Battery Life: 4-6 Hours (time may vary upon use) - UHF Frequency: 625 Mhz Band - Color Finish: Matte Black - Dimensions: 9.5" H., 1.5" Dia. (Tapered Body), 2" Dia. (Mic. Head). (242 mm X 38 mm Dia. (Body) X 51 mm Dia. (Mic Head) - Net Weight: 9 Oz. (255 grams) . Batteries not included.

MODEL PTR200 - DUAL UHF RECEIVER/TRANSMITTER BASE STATION

The PTR200 is a dual UHF Wireless Base Station. Will accept either two optional RM190 Receiver Modules (Dual UHF Wireless System, Transmitters are required (see next page)) or one optional RM190 UHF Receiver and one optional TM190 UHF Transmitter/Repeater or one optional TM190 UHF Transmitter only.

PTR200 SHOWN WITH OPTIONAL TM190U UHF TRANSMITTER



PRK251 - 19" (1U) SINGLE UNIT RACK MOUNT KIT

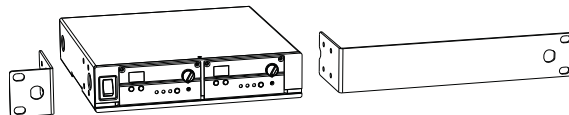

PRK252 - 19" (1U) DUAL UNIT RACK MOUNT KIT (SIDE BY SIDE)

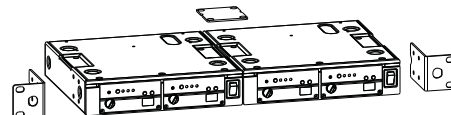

PTR200 - REAR PANEL



PTR200 - DUAL PORT UHF WIRELESS BASE STATION

Dual Port accept two RM190U Receiver Modules or one TM190U Transmitter Module or one RM190U Receiver Module and one TM190U Transmitter Module (Transmitter/Repeater Configuration) - Panel Color Finish: Matte Black - Dimensions: 6" D., 3" W., 1.5" H. (153 mm X 77 mm X 38 mm) - Net Weight: 9 Oz (255 grams). Complete with AC Adapter. Supplied with two UHF Antennas.

PTR200 CONFIGURATION TABLE

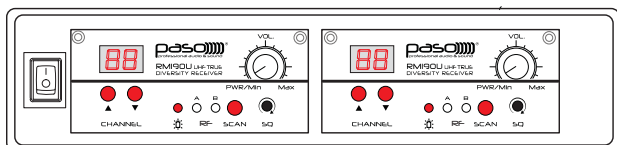

USING TWO RM190U 100 CHANNEL UHF RECEIVERS

Up to two 100 Channel UHF Frequency Agile Receivers may be used with the PTR200. Receivers are plug-in and easily install on the front panel ports provided. The two Receivers can be simultaneously operated by using the optional Transmitters MW293 Beltback or MW295 Hand-Held described on the next page.

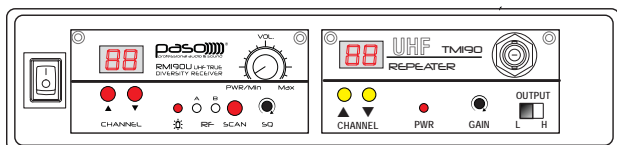

USING ONE RM190U UHF RECEIVER AND ONE TM190U TRANSMITTER

In this configuration the UHF Receiver audio output is routed to the Transmitter audio input for re-broadcasting (Repeater) to other UHF Receivers operating at the Transmitter set frequency channel (up to 800 Ft. distance).

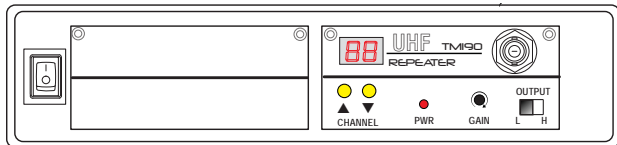

USING ONE TM190U 100 CHANNEL UHF TRANSMITTER

Up to one 100 Channel UHF Frequency Agile TM190U Transmitter may be used with the PTR200. In this configuration the Transmitter can broadcast up to 800 Ft. to various UHF Receivers operating at the same frequency. Ideally suited for Transmitting via UHF to numerous Wireless Portable Sound Systems.

MODEL RM190U - OPTIONAL 100 CHANNEL UHF FREQUENCY AGILE RECEIVER MODULE



RM190U - 100 CH. UHF TRUE DIVERSITY PLUG-IN RECEIVER MODULE

LED Channel Selector Display - Channel Selectors: UP-DOWN - Power Switch with Audio Level Control - Squelch Control - Autoscan Button - RF-AB LED Diversity Indicators - Transmitter low battery indicator - UHF Frequency: 625 Mhz Band - Panel Color Finish: Matte Black - Dimensions: 8" W, 8.75" D., 1.75" H. (200 mm X 220 mm X 44 mm) - Net Weight: 9 Oz (255 grams). OPERATES ON THE 625 MHZ UHF BAND

MODEL TM190U - OPTIONAL 100 CHANNEL UHF FREQUENCY AGILE TRANSMITTER MODULE

TM190U - 100 CHANNEL UHF PLUG-IN TRANSMITTER MODULE

Mounts on Front Panel Port - Display Screen: 7-segment LED - Channel Selectors: UP-DOWN - Power Switch with Audio Level Control - HI - LO Power Output Switch - High 50mW, Low 35mW - Spurious Emission > 60 dB below carrier - Dynamic Range > 110 dB - T.H.D. < 0.5% - UHF Frequency: 625 Mhz Band - Antenna Socket TNC type - Panel Color Finish: Matte Black - Dimensions: 6" D., 3" W., 1.5" H. (153 mm X 77 mm X 38 mm) - Net Weight: 9 Oz (255 grams). OPERATES ON THE 625 MHZ UHF BAND



MODEL PR400 - QUAD UHF RECEIVER BASE STATION

The PR400 is a quad UHF Wireless Base Station. Will accept up to four optional RM190 Receiver Modules (Four UHF Wireless Microphone System) all into one unit of vertical Rack space. Optional UHF Transmitters Models MW293 Beltpack, MW295 Hand-Held or WBM500/18 Desk base are required (see below).

PR400 - QUAD PORT UHF WIRELESS RECEIVER BASE

Quad Port accept up to four RM190U Receiver Modules - All Receivers may be operated simultaneously. Panel Color Finish: Matte Black - Independent Receiver Audio Out Balanced. Mixed Audio Out either Line or MIC Level with selector switch. Built-in True-Diversity Antenna Combiner. Terminations: Independent Channel Audio Out: XLR Connector - Mixed Audio Out Line: 1/4 Phono Jack, MIC = XLR Connector Balanced. Antenna: TNC Female Connector. Power Requirement: 100-240 Volt (Switching Power Supply) Rack Mounting included. Dimensions: Front Panel = 19" W., 1.75" H. (483 X 45 mm) Cabinet = 16.5" W., 10.25" D., 1.6" H. 6" D., 3" W., 1.5" H. (420 X 261 X 41 mm) - Net Weight: 6.25 Lbs (2.85 Kg). Supplied with two UHF Antennas.

MODEL PR400 - FRONT PANEL - Photo Shown with optional RM190 Modules Installed



MODEL PR400 - REAR PANEL



MODEL RC21 - 19" METAL ROAD CARRYING CASE FOR PR400



RC21 - PR400 19" METAL ROAD CARRYING CASE

Heavy-Duty Metal Carrying Case for PR400. Removable Front and Rear Covers. Covers Metal Snap-Latches. 19" Rack Mounting Housing. Reinforced Corners and Large Carrying Handle. Finish: Silver and Black. Dual removable Covers with Storage Compartment. Dimensions: 20.5" W., 16" D., 3" H. (520 X 406 X 76 mm) Net Weight: 5.6 Lbs (2.6 Kg) empty.

SHOWN WITH OPTIONAL PR400 AND FOUR RM190U RECEIVERS INSTALLED

MW293 - 100 CHANNEL UHF PENDANT/BELTPACK TRANSMITTER

Complete with Electret Microphone, Wind Screen and Tie Clip - MIC Input Termination: 4-pin XLR Mini Connector - Multifunction LCD Display - Channel Selector: Digital on Display - Power Switch with Auto turn-off - Audio ON/OFF Mute Switch with LED Indicator - Battery Type: 2 X 1.5 V AA - Battery Life: 4-6 Hours (time may vary upon use) - UHF Frequency: 625 Mhz Band - Color Finish: Matte Black - Dimensions: 3.75" H. (7.5" including Antenna), 2.5" W., 1.2" D. (including Belt Clip). (95 mm (191 mm with antenna) X 65 mm X 31 mm) - Net Weight: 3 Oz. (76 grams). Batteries not included. **TRANSMITTER OPERATES ON THE 625 MHZ UHF BAND.**

MW295 - 100 CHANNEL UHF HANDHELD TRANSMITTER

Microphone: Unidirectional Dynamic - Low Handling Noise - Multifunction LCD Display - Channel Selector: Digital on Display - Power Switch - Momentary ON LED Indicator - Battery Type: 2 X 1.5 V AA - Battery Life: 4-6 Hours (time may vary upon use) - UHF Frequency: 625 Mhz Band - Color Finish: Matte Black - Dimensions: 9.5" H., 1.5" Dia. (Tapered Body), 2" Dia. (Mic. Head). (242 mm X 38 mm Dia. (Body) X 51 mm Dia. (Mic Head) - Net Weight: 9 Oz. (255 grams) . Batteries not included. **TRANSMITTER OPERATES ON THE 625 MHZ UHF BAND.**

WBM500/18 - 100 CHANNEL UHF DESK BASE TRANSMITTER

Microphone: Removable Unidirectional Electret with 18" (43 cm) Gooseneck and XLR Connector - Multifunction LCD Display - Channel Selector: Digital on Display - Gain Control - XLR Connector: MIC Output and Line Input on rear panel - Illuminated Push to talk and Push to Lock Pads - Power Switch - Power LED Indicator - Battery Type: 2 X 1.5 V AA - Battery Life: 4-6 Hours (time may vary upon use) - UHF Frequency: 625 Mhz Band - Color Finish: Dark Grey and Silver - Dimensions Base: 5" W., 6" D. (Tapered) (127 mm X 153 mm), Gooseneck Mic: 18" H. ((430 mm) - Net Weight: 1.7 Lbs (800 grams) . AC Adapter/Recharger included - Batteries not included. **TRANSMITTER OPERATES ON THE 625 MHZ UHF BAND.**

50 WATT - MODULAR - CLASS "D" ALL DIGITAL WIRELESS PORTABLE SOUND SYSTEM

The WPCS50M is a sophisticated, compact, highly versatile sound system specifically engineered for a variety of Multimedia Sound Reinforcement Applications. The numerous available options allow to tailor a system that suits the individual requirement with maximum performance, efficiency and cost effectiveness. The rugged, compact enclosure makes the unit easy to carry and easy to install anywhere indoor or outdoor.



AC-DC - 50 W HIGH PERFORMANCE - PLL-UHF 16 CHANNEL FREQUENCY AGILE - CLASS "D" AMPLIFIER ALL DIGITAL - WIRELESS PORTABLE SOUND SYSTEM

- ⚙️ COVERS AN AUDIENCE OF 800 OR MORE
- ⚙️ INDOOR OUTDOOR OPERATION
- ⚙️ HIGH INTELLIGIBILITY - SUPERIOR SOUND
- ⚙️ SUPPLIED WITH WIRED MICROPHONE
- ⚙️ VERSATILE MULTIMEDIA COMPACT SYSTEM
- ⚙️ RUGGED - HIGH IMPACT ENCLOSURE
- ⚙️ AC - DC OPERATION
- ⚙️ REMOVABLE RECHARGEABLE BATTERY (SUPPLIED)
- ⚙️ INDEPENDENT INPUT LEVEL CONTROLS
- ⚙️ UP TO 2 UHF WIRELESS SYSTEM OPERATION
- ⚙️ MAY BE WALL MOUNTED WITH OPTIONAL BRACKET
- ⚙️ SUPPLIED WITH ONE WIRELESS RECEIVER (TRANSMITTER REQUIRED)

The acoustically engineered Speaker System provides controlled sound dispersion with maximum power output concentration where it is needed. Sound coverage is uniform, with full articulation of speech in the entire area served. The Unidirectional Wireless Microphone is combined with an effective Speaker System that greatly minimizes feedback "howl" and reverberation resulting when sound bounces from ceiling and wall surfaces. Whether you address small or large audiences, your voice is carried over effectively and efficiently. The WPCS50M will cover an area up to 20,000² Feet (1,900² Meters).

M O D E L - WPCS50M

WIRELESS SYSTEM OPERATES ON THE 625 MHZ UHF BAND

Model WPCS50M - 50W Basic System with one built-in 16 Channel UHF Receiver and the M555 Unidirectional Microphone with cable

*** OPTIONAL MODULAR EQUIPMENT**

*** OPTIONAL EQUIPMENT**

simply build your system . . .



RM161U - 16 Channel UHF Receiver Factory or Dealer installed) *



WMB50 Wall Mount Bracket for WPCS50M and PASS50 *



SC50 Soft Carrying Case with zippered pockets *



B43B Floor Stand



SW150 150 WATT AC ONLY Powered Subwoofer*



WPCS50 REAR PANEL SHOWN WITH OPTIONAL MODULES INSTALLED



PASS50 - AUXILIARY SPEAKER SYSTEM *
matches the WPCS50M in size and aesthetics. Complete with cable



DVDM5U DVD Player

DVD PLAYER - PLAYS DVDR/DVDRW/CDR/CDRW/MP3 AND USB THUMB DRIVE MP3 TRACKS - REMOTE CONTROL INCLUDED *



MP3M50 MP3 Recorder Player

DIGITAL RECORDING AND PLAYBACK - SD MEMORY CARD SLOT - BUILT-IN 128 MB RESIDENT MEMORY - USB PORT FOR PC CONNECTION *



MW326 UHF Handheld Transmitter *



MW323 UHF Pendant/Beltpack Transmitter *
Includes Tie Clip Electret Microphone

M555 Mini, Dynamic Unidirectional Microphone (INCLUDED)

MW323 - 16 CHANNEL UHF PENDANT/BELTPACK TRANSMITTER

Supplied with Electret Microphone, Wind Screen and Tie Clip - Complete with Lanyard and Belt Clip - MIC Input Termination: 4-pin XLR Mini Connector - Multifunction LCD Display - Channel Selector: Digital on Display - Power Switch - Audio ON/OFF Mute Switch with LED Indicator - Battery Type: 2 X 1.5 V AA - Battery Life: 4-6 Hours (time may vary upon use) - UHF Frequency: 625 Mhz Band - Color Finish: Matte Black - Dimensions: 3.75" H. (7.5" including Antenna), 2.5" W., 1.2" D. (including Belt Clip). (95 mm (191 mm with antenna) X 65 mm X 31 mm) - Net Weight: 3 Oz. Batteries not included. **TRANSMITTER OPERATES ON THE 625 MHZ UHF BAND.**

MW326 - 16 CHANNEL UHF HAND-HELD TRANSMITTER

Microphone: Unidirectional Dynamic - Low Handling Noise - Multifunction LCD Display - Channel Selector: Digital on Display - Power Switch - Momentary ON LED Indicator - Battery Type: 2 X 1.5 V AA - Battery Life: 4-6 Hours (time may vary upon use) - UHF Frequency: 625 MHz Band - Color Finish: Matte Black - Dimensions: 9.5" H. , 1.5" Dia. (Tapered Body), 2" Dia. (Mic. Head). (242 mm X 38 mm Dia. (Body) X 51 mm Dia. (Mic Head) - Net Weight: 9 Oz. Batteries not included. **TRANSMITTER OPERATES ON THE 625 MHZ UHF BAND**

150 WATT ALL DIGITAL PORTABLE SOUND SYSTEM

The WPSS150M is a sophisticated, high power, highly versatile digital sound system specifically engineered for a variety of Multimedia Sound Reinforcement Applications. The numerous available options allow to tailor a system that suits the individual requirement with maximum performance, efficiency and cost effectiveness. The rugged, compact enclosure makes the unit easy to carry and easy to install anywhere indoor or outdoor.



AC-DC - 150 W HIGH PERFORMANCE - PLL-UHF 100 CHANNEL FREQUENCY AGILE - CLASS "D" AMPLIFIER ALL DIGITAL - WIRELESS PORTABLE SOUND SYSTEM

- ⚙️ COVERS AN AUDIENCE OF 2000 OR MORE
- ⚙️ INDOOR OUTDOOR OPERATION
- ⚙️ HIGH INTELLIGIBILITY - SUPERIOR SOUND
- ⚙️ SUPPLIED ACCESSORIES CARRYING CASE
- ⚙️ VERSATILE MULTIMEDIA COMPACT SYSTEM
- ⚙️ RUGGED - HIGH IMPACT ENCLOSURE
- ⚙️ AC - DC OPERATION
- ⚙️ BUILT-IN RECHARGEABLE BATTERY (SUPPLIED)
- ⚙️ INDEPENDENT INPUT LEVEL CONTROLS
- ⚙️ HIGH POWER TRIAXIAL SPEAKER SYSTEM
- ⚙️ UP TO 4 UHF WIRELESS SYSTEM OPERATION
- ⚙️ OR UP TO 3 UHF RECVRs AND 1 UHF TRANSMITTER
- ⚙️ BUILT-IN CASTERS AND 3 STAGE HANDLE
- ⚙️ COVERS AN AREA UP TO 25,000 SQ. FT. (2,400 SQ METERS)

RM190U - 100 CHANNEL UHF TRUE DIVERSITY PLUG-IN RECEIVER MODULE

Mounts on WPSS150M Rear Panel - LED Channel Selector Display - Channel Selectors: UP-DOWN - Power Switch with Audio Level Control - Squelch Control - Autoscan Button - RF-AB LED Diversity Indicators - Transmitter low battery indicator - UHF Frequency: 625 Mhz Band - Panel Color Finish: Matte Black - Dimensions: 6" D., 3" W., 1.5" H. (153 mm X 77 mm X 38 mm) - Net Weight: 9 Oz (255 grams). **RECEIVER OPERATES ON THE 625 MHZ UHF BAND.**

M O D E L - WPSS150M



SOUNDCASTER 150 - 150 WATT ALL DIGITAL PORTABLE SOUND SYSTEM

Model WPSS150M - 150W Basic System with built-in rechargeable battery. See expansion modules below.

* OPTIONAL MODULAR EQUIPMENT

simply build your system . . .

WPSS150M REAR PANEL SHOWN WITH OPTIONAL MODULES INSTALLED

RM190U
100 Channel
UHF Receiver
Module *

* OPTIONAL EQUIPMENT



SC100 Soft
Cover with
zippered
pockets *



WMB150
Wall Mount
Bracket
Heavy Duty



B41B
Floor
Stand

**PASS100 - AUXILIARY
SPEAKER SYSTEM ***
matches the WPSS100M in size
and aesthetics. Complete with cable



UHF TRANSMITTER MODULE
TM190 - 100 CHANNEL
TRANSMITTER/REPEATER
MODULE. TRANSMITS ALL
SOURCES FROM THE WPSS150 TO
A SECOND REMOTE WPSS150 *



DVDMSU
DVD
Player

**DVD PLAYER - PLAYS
DVDR/DVDRW/CDR/CDRW/MP3 AND USB
THUMB DRIVE MP3 TRACKS - REMOTE
CONTROL INCLUDED ***



MP3M50
MP3 Recorder
Player

**DIGITAL RECORDING AND PLAYBACK
- SD MEMORY CARD SLOT - BUILT-IN
128 MB RESIDENT MEMORY - USB
PORT FOR PC CONNECTION ***



MW295
100 Channel UHF
Handheld
Transmitter *



MW293
100 Channel UHF
Pendant/Belt Pack
Transmitter *
Includes Tie Clip
Electret Microphone

WBM500
100 Channel UHF
Desk Base
Transmitter *

WM293 - 100 CHANNEL UHF PENDANT/BELTPACK TRANSMITTER

Complete with Electret Microphone, Wind Screen and Tie Clip - MIC Input Termination: 4-pin XLR Mini Connector - Multifunction LCD Display - Channel Selector: Digital on Display - Power Switch with Auto turn-off - Audio ON/OFF Mute Switch with LED Indicator - Battery Type: 2 X 1.5 V AA - Battery Life: 4-6 Hours (time may vary upon use) - UHF Frequency: 625 Mhz Band - Color Finish: Matte Black - Dimensions: 3.75" H. (7.5" including Antenna), 2.5" W., 1.2" D. (including Belt Clip). (95 mm (191 mm with antenna) X 65 mm X 31 mm) - Net Weight: 3 Oz. (76 grams). Batteries not included. **TRANSMITTER OPERATES ON THE 625 MHZ UHF BAND.**

MW295 - 100 CHANNEL UHF HANDHELD TRANSMITTER

Microphone: Unidirectional Dynamic - Low Handling Noise - Multifunction LCD Display - Channel Selector: Digital on Display - Power Switch - Momentary ON LED Indicator - Battery Type: 2 X 1.5 V AA - Battery Life: 4-6 Hours (time may vary upon use) - UHF Frequency: 625 Mhz Band - Color Finish: Matte Black - Dimensions: 9.5" H., 1.5" Dia. (Tapered Body), 2" Dia. (Mic. Head). (242 mm X 38 mm Dia. (Body) X 51 mm Dia. (Mic Head) - Net Weight: 9 Oz. (255 grams) . Batteries not included.

TRANSMITTER OPERATES ON THE 625 MHZ UHF BAND.

WBM500/18 - 100 CHANNEL UHF DESK BASE TRANSMITTER

Microphone: Removable Unidirectional Electret with 18" (43 cm) Gooseneck and XLR Connector - Multifunction LCD Display - Channel Selector: Digital on Display - Gain Control - XLR Connector: MIC Output and Line Input on rear panel - Illuminated Push to talk and Push to Lock Pads - Power Switch - Power LED Indicator - Battery Type: 2 X 1.5 V AA - Battery Life: 4-6 Hours (time may vary upon use) - UHF Frequency: 625 Mhz Band - Color Finish: Dark Grey and Silver - Dimensions Base: 5" W., 6" D. (Tapered) (127 mm X 153 mm), Gooseneck Mic: 18" H.. ((430 mm) - Net Weight: 1.7 Lbs (800 grams) . AC Adapter/Recharger included - Batteries not included.

TRANSMITTER OPERATES ON THE 625 MHZ UHF BAND.

50 WATT - CLASS "D" ALL DIGITAL WIRED OR WIRELESS PORTABLE SOUND SYSTEM

MODELS - TA50 AND WTA50 WIRELESS

The TA50 (WTA50) is a sophisticated, compact, highly versatile sound system specifically engineered for a variety of Multimedia Sound Reinforcement Applications. The numerous available options allow to tailor a system that suits the individual requirement with maximum performance, efficiency and cost effectiveness. The rugged, compact enclosure makes the unit easy to carry and easy to use anywhere indoor or outdoor.



OPTIONAL MW326
HAND-HELD
TRANSMITTER

OPTIONAL MW323
PENDANT/BELTPACK
TRANSMITTER

AC-DC - 50 W HIGH PERFORMANCE - PLL-UHF 16 CHANNEL FREQUENCY AGILE - CLASS "D" AMPLIFIER ALL DIGITAL - WIRELESS PORTABLE SOUND SYSTEM

- MORE THAN 200 FT (60 Meters) EFFECTIVE RANGE
- INDOOR OUTDOOR OPERATION
- HIGH INTELLIGIBILITY - SUPERIOR SOUND
- SUPPLIED WITH WIRED MICROPHONE
- Built-in USB Port and MP3 Player (WTA50 only)
- RUGGED - HIGH IMPACT ENCLOSURE
- AC - DC OPERATION
- Built-in LITHIUM ION Rechargeable Battery
- INDEPENDENT INPUT LEVEL CONTROLS
- RETRACTABLE CARRYING HANDLE
- SUPPLIED WITH SHOULDER STRAP
- MAY BE MOUNTED ON A FLOOR STAND
- 16 Ch. UHF RECEIVER (WTA50 only) requires Transmitter

The acoustically engineered Speaker System provides controlled sound dispersion with maximum power output concentration where it is needed. Sound coverage is uniform, with full articulation of speech in the entire area served. The Unidirectional Wireless Microphone is combined with an effective Speaker System that greatly minimizes feedback "howl" and reverberation resulting when sound bounces from ceiling and wall surfaces. Whether you address small or large audiences, your voice is carried over effectively and efficiently. The TA50-WTA50 has an effective Voice Range in excess of 200 Ft. (61 Meters).

MODEL TA50 - BASIC SYSTEM WITH M555 DYNAMIC MICROPHONE



MODEL WTA50 - BUILT-IN 16 CHANNEL UHF RECEIVER - USB MP3 PLAYER AND M555 UNIDIRECTIONAL DYNAMIC MICROPHONE WITH CABLE



WIRELESS SYSTEM OPERATES ON THE 625 MHZ UHF BAND



Model PAD416 - UHF Diversity Antenna Distribution System

The PAD416 is an active unity-gain, UHF Diversity Antenna Distribution System. It provides one REMOTE ANTENNA A Input to four Receiver Outputs and one REMOTE ANTENNA B Input to four Receiver Outputs. The PAD416 also provides DC Power to up to four Diversity Receivers (12V - 14V). Rack Mount Ears, prewired BNC to BNC Antenna Cables, DC Power Cables and BNC/TNC Connector Adapters for the Diversity Receivers are included. The Remote Antennas AR216, DA80, Antenna Boosters AB80, and RF connecting cables are optional.



Frequency Range: 600 to 1000 Mhz
Input Impedance: 50 ohm
Output Impedance: 50 ohm
Nominal Gain: 0 dB
BNC Antenna Jacks: 4 Antenna A, 4 Antenna B
Remote Ant. Jacks: 1 Antenna A, 1 Antenna B
DC Power Output: 12V - 14V, 3.6 A
DC Output Jack: Four 12 - 14 VDC
Power Requirement: 100 - 240 V, 50-60 hZ
Rack Mount: 19" with Rack Ears supplied
Rack Space: 1 Unit of vertical space
Dimensions: 17" W., 7.75" D., 1.75" H.
 (432 X 197 X 45 mm)
Net Weight: 3.6 Lb. (1.65 Kg)

The PAD416 System includes: 8 - 6 ft. (1 m) BNC to TNC Coax. Cables, 8 BNC to TNC Adapters, 4 DC Supply Cables, 2-1/4 Wave UHF Antennas, 2 Rack Ears and 1 Power Cord.

BLOCK DIAGRAM - The Block Diagram shows the PAD416 with 4 RDU2500 UHF Diversity Receivers, 2 optional AR216 Remote Antenna and 2 optional AB80 Antenna Booster. The Antenna Booster is required only if the distance between the PAD416 and the AR216 Antenna exceeds 100 ft.. Please note that if it is required for the RDU2500 Receivers to be mounted in a Rack the optional PRK216 Rack Kit is required, one Kit for two receivers.

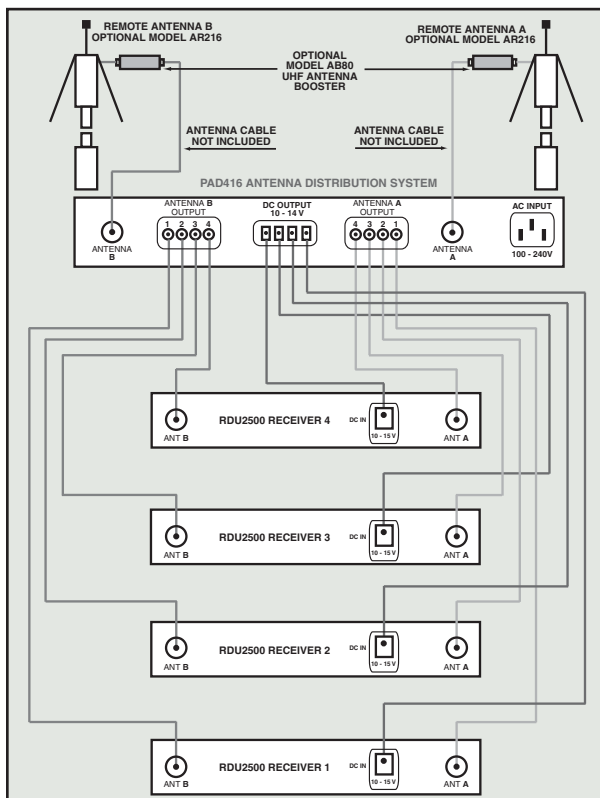

Accessories

SPECIFICATIONS

DA-80 - UHF Unidirectional Antenna - Wideband design for use with all UHF Wireless Systems. Increased range and reduced interference as compared to omnidirectional 1/2-wave antennas. Improves RF Signal Gain by up to 10 dB or more. Radiation Pattern: Directional, Cardioid. Frequency Range: 470 ~ 952 Mhz - Input Termination: BNC Female - Dimensions: 10.5" W., 12" H., 1.10" D. (267X305X28 mm) Net Weight: 10.4 oz (295 grams) Mounting: 5/8"-27 thread on integral swivel adapter bracket for mounting on flange or on microphone stand. Shipped in pair for diversity systems. May be wall or ceiling mounted with WMB50 listed on page 21. RF Cable not included.



DA-80 UHF Unidirectional Antenna

The AR216 consists of one base assembly, four antenna rods, one mounting flange, one straight and one curved mounting arm for 90° wall installation. The RF cable for connection to the PAD416 is not supplied.



AR216 Remote UHF Ground Plane Antenna

AB80 UHF Antenna Booster

AR216 - UHF Ground Plane Antenna - Frequency Range: 600 ~ 1000 Mhz - Input Termination: BNC Male - Mounting: 5/8"-27 thread on rod for mounting on flange (supplied) or on microphone stand - 90° elbow adapter for wall mounting - Dimensions: 19.25" (489 mm) H. fully extended - Net - Weight: 1 Lb (0.45 Kg) - 2 Antennas are required for diversity system. Termination: BNC Female. RF Cable not included.

AB80 - Antenna Booster - Frequency Range: 600~1000 Mhz - Input Gain: +12.5 dB - Noise: <1.4 dB - Input/Output: Impedance: 50 ohm - Terminations: BNC Male to BNC Female - Dimensions: 4" L. (including Connectors), 1.25" Diameter: (105 X 32 mm) - Net Weight: 0.22 Lb (0.2 Kg) - Mounts in series with Antenna RF Cable.

PRK-AM416 - Rack Ears with Antenna Mounts for RDU2500 - 1 pair includes BNC Connectors and 12" Prewired Cables for connection to the Receiver.



Solid Hardwood and Laminate Sound Powered Lecterns and Cabinets



PASO has continuously produced Sound Lecterns for over 50 Years. First introduced in 1960 the SOUND LECTERN was a new Sound Reinforcement System concept. Produced in large quantity, the integration of a PA Amplifier, a Sound Column Speaker System and a Microphone into a Lectern Cabinet, quickly became a success. Today, PASO manufactures a complete line of Sound Lecterns to meet a variety of applications and budgets. PASO Lecterns are known for their high quality and high performance standards. Several models are available in a choice of traditional color finishes that will complement any room decor or architectural style.

CABINETRY - The Solid Hardwood models are handcrafted and constructed by using the finest Solid Hardwoods and Veneers. All solid hardwood and veneers are matched, hand sanded and then stained to highlight the natural grain of the woods. Finally two hard coat finishes are hand buffed to a satin non-glare finish to provide long lasting protection and to bring out the unequalled beauty and distinction of the natural wood. The classic design and the commanding size make the Lecterns ideally suited for boardrooms, conference rooms, convention centers, auditoriums, large meeting rooms, schools, hospitals, hotels, restaurants, etc.

SOUND SYSTEM - The PASO Lectern's Sound System has been specifically engineered to provide clean, uniform sound dispersion with amazing power and clarity and twice the power output of similar competitive models. Acoustic feedback is virtually eliminated by using a directional Sound Column Speaker design, Unidirectional Dynamic Microphone and Speech Filter Equalization. Most models will effectively cover audiences of 2500 or more indoor. All models may be used outdoor.

ALL WOOD CABINET MODELS AVAILABLE WITH OR WITHOUT SOUND SYSTEM

SOUND SYSTEM

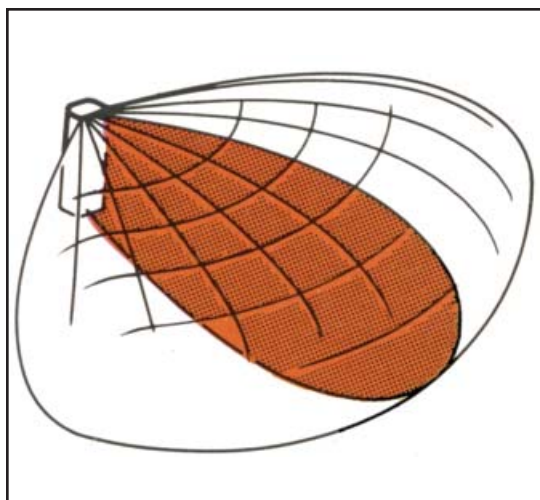

The figure at left shows the vertical and horizontal sound radiation pattern of the Sound Column Lecterns. The acoustically engineered sound column enclosure provides controlled sound dispersion with maximum power output concentration where it is needed. Sound coverage is uniform, with full articulation of speech in the entire area served. The built-in electronic Speech-Filter Equalizer greatly minimizes feedback "howl" and reverberation resulting when sound bounces from ceiling and wall surfaces. Whether you address small or large audiences, your voice is carried over effectively and efficiently. The Lectern will cover an area up to 20,000² Feet (2,000² Meters).

The large figure at left shows the approximate "Effective Sound Range" of a Paso Sound Column Lectern when used at rated power. Approx. Range: 250 Ft. (80 m.).

TILT AND ROLL™

TILT AND ROLL™: Selected models incorporate two recessed casters within the floor base. By tilting the cabinet rearward, the Lectern can be easily moved from location to location. Once the Lectern is returned to its vertical position, the Lectern is stationary and locked in position.

DC OPERATION

DC OPERATION: Most models may be operated on DC by using the optional rechargeable battery pack (see accessories). The battery is automatically recharged by the built-in recharger when the Lectern is operated on AC.

All PASO Lecterns and Cabinets are Handcrafted in the USA

150 WATT SOUND POWERED LECTERN - CLASS **D** DIGITAL AMPLIFIER

MODELS

SL600 - 150 WATT POWERED SOUND COLUMN LECTERN - HARDWOOD FINISH

SL600NO NATURAL OAK - SL600DO DARK OAK - SL600NW NATURAL WALNUT

SL600NM NATURAL MAHOGANY - SL600DM DARK MAHOGANY - SL600RM RED MAHOGANY

150 Watt Sound Powered Lecterns Exceptional Power and Clarity

*Class D Digital Amplifier - Optional UHF Wireless Microphones
Optional DVD/CD/USB Player and MP3 Digital Recorder Modules
WILL COVER AN AUDIENCE OF 2500 OR MORE*

*Reading Light
Retractable Projector Shelf
Locking Compartment
Utility Shelf
Casters for Mobility
DC operation with optional Battery*



Rear View

Computer and Projector not supplied

The extremely flexible "**MODULAR**" concept allows the Lectern to be fitted with a number of Modules to meet the individual application with maximum cost effectiveness !

* OPTIONAL MODULAR EQUIPMENT

SL400 - SL500 - SL600
CONTROLS REAR PANEL SHOWN
WITH OPTIONAL MODULES INSTALLED



RM190U
100 Channel
UHF Receiver
Module *
Up to 4 Modules
may be used



MW295
100 Channel UHF
Handheld
Transmitter *



MW293
100 Channel UHF
Pendant/Belt Pack
Transmitter *



PROJECTOR/
COMPUTER
SIDE SHELF
EXTENDED



TM190 - 100 CHANNEL
TRANSMITTER/REPEATER
MODULE. TRANSMITS ALL
SOURCES FROM THE
LECTERN TO THE POWERED
SLAVE UNIT*

DVDM5U - DVD PLAYER - PLAYS
DVDR/DVDRW/CDR/CDRW/MP3
AND USB THUMB DRIVE MP3
TRACKS - REMOTE CONTROL
INCLUDED *



MP3M50 - MP3 RECORDER/PLAYER
DIGITAL RECORDING AND PLAY-
BACK - SD MEMORY CARD SLOT -
BUILT-IN 128 MB RESIDENT MEMORY
- USB PORT FOR PC CONNECTION *



WBM500
100 Channel UHF
Desk Base
Transmitter *



ECO-Friendly
Green Product



All PASO Lecterns and Cabinets are Handcrafted in the USA

Solid Hardwood Cabinets and Digital Sound Powered Lecterns



SL 400 - 150 Watt - SOLID HARDWOOD SOUND POWERED LECTERN

AC and Optional DC Operation
Class **D** Digital Amplifier

Covers an audience of up to 1500

Handcrafted Lectern constructed by using the finest Solid Hardwoods and Veneers. The reading table is wide and deep providing over 300² inches of usable surface. A recessed reading light is provided. The classic design and the commanding size makes this Lectern ideally suited for boardrooms, conference rooms, convention centers, auditoriums, large meeting rooms, schools, hospitals, hotels, restaurants, etc. The SL400 Sound System has been specifically engineered to provide clean, uniform sound dispersion with amazing power and clarity and twice the output power of similar competitive models. Acoustic feedback is virtually eliminated by using a directional Sound Column Speaker design, Unidirectional Dynamic Microphone and Speech Filter Equalization. The Sound Lectern will effectively cover audiences of 1500 or more indoor. Dimensions: 48" H., 22½" W., 21¼" D. Net Weight: 70 Lbs (34 Kg).

AVAILABLE WITH OR WITHOUT SOUND SYSTEM
(see below for models available)

- ☐ Optional Wireless Microphone (Up to 4)
- ☐ Optional DVD/CD/USB Player
- ☐ Unidirectional Dynamic Microphone
- ☐ Powerful Sound Column Speaker System
- ☐ Built-In Speech Filter Equalizer
- ☐ Volume and Tone Controls
- ☐ Output for Auxiliary Speaker
- ☐ Inputs for up to two Wired Microphones
- ☐ Output for Tape Recording Device
- ☐ Recessed Casters for Mobility
- ☐ Recessed Reading Light
- ☐ DC Operation with Optional Battery

MODELS WITH SOUND

Model No.	Cabinet Finish
SL400DO -	Dark Oak
SL400NW -	Natural Walnut
SL400NO -	Natural Oak
SL400NM -	Natural Mahogany
SL400DM -	Dark Mahogany
SL400RM -	Red Mahogany

CABINETS ONLY

Model No.	Cabinet Finish
SLC400DO -	Dark Oak
SLC400NW -	Natural Walnut
SLC400NO -	Natural Oak
SLC400NM -	Natural Mahogany
SLC400DM -	Dark Mahogany
SLC400RM -	Red Mahogany

SEE OPTIONAL UHF WIRELESS SYSTEMS
& DVD/CD/USB PLAYER
MP3 RECORDER MODULES ON PAGE 29



ECO-Friendly
Green Product



Rear View

DIMENSIONAL DRAWINGS

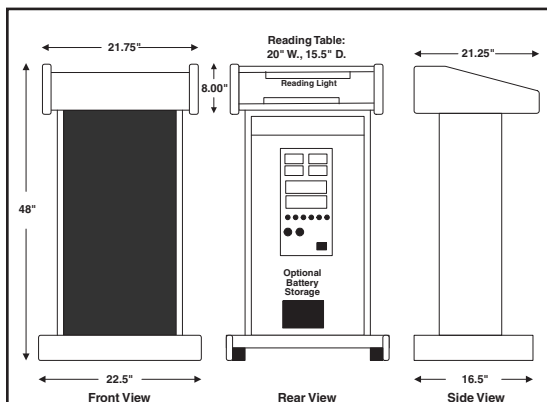

FEATURES

TILT AND ROLL:™ The Lectern incorporates two recessed casters within the floor base. By tilting the cabinet rearward, the Lectern can be easily moved from location to location. Once the Lectern is returned to its vertical position, the Lectern is stationary and locked in position.

DC OPERATION: The Lectern may be operated on DC by using the optional rechargeable battery pack (see accessories). The battery is automatically recharged by the built-in recharger when the Lectern is operated on AC.

ACCESSORIES

M941M - Auxiliary Unidirectional Dynamic Microphone. Complete with 15ft (5 m) Cable and XLR male connector.

27/12 - 12 Volt sealed rechargeable battery pack. Lectern operates 5-6 hours on each charge. Mounts inside Lectern. Two required.

CV24 - 30ft. (10 m) Microphone Extension Cable complete with XLR connectors.



Solid Hardwood Cabinets and Digital Sound Powered Lecterns

Wide Body - Solid Hardwood Cabinets and Digital Sound Powered Lecterns



SL 500 - 150 Watt - 25" Wide Body SOLID HARDWOOD SOUND POWERED LECTERN

AC and Optional DC Operation

Class **D** Digital Amplifier

Covers an audience of up to 2500

Handcrafted Lectern constructed by using the finest Solid Hardwoods and Veneers. The reading table is wide and deep providing over 300² inches of usable surface. A recessed reading light is provided. The classic design and the commanding size makes this Lectern ideally suited for boardrooms, conference rooms, convention centers, auditoriums, large meeting rooms, schools, hospitals, hotels, restaurants, etc. The SL500 Sound System has been specifically engineered to provide clean, uniform sound dispersion with amazing power and clarity and twice the output power of similar competitive models. Acoustic feedback is virtually eliminated by using a directional Sound Column Speaker design, Unidirectional Dynamic Microphone and Speech Filter Equalization. The Sound Lectern will effectively cover audiences of 2500 or more indoor. Dimensions: 49" H., 25" W., 23" D. Net Weight: 90 Lbs (41 Kg).

AVAILABLE WITH OR WITHOUT SOUND SYSTEM
(see below for models available)

SEE OPTIONAL UHF WIRELESS SYSTEMS
& DVD/CD/USB PLAYER
MP3 RECORDER MODULES ON PAGE 29

- ☐ Unidirectional Dynamic Microphone
- ☐ Powerful Sound Column Speaker System
- ☐ Built-In Speech Filter Equalizer
- ☐ Volume and Tone Controls
- ☐ Output for Tape Recording Device
- ☐ Recessed Casters for Mobility
- ☐ Recessed Reading Light
- ☐ DC Operation with Optional Battery



ECO-Friendly
Green Product



MODELS WITH SOUND

Model No.	Cabinet Finish
SL500DO -	Dark Oak
SL500NW -	Natural Walnut
SL500NO -	Natural Oak
SL500NM -	Natural Mahogany
SL500DM -	Dark Mahogany
SL500RM -	Red Mahogany

CABINETS ONLY

Model No.	Cabinet Finish
SLC500DO -	Dark Oak
SLC500NW -	Natural Walnut
SLC500NO -	Natural Oak
SLC500NM -	Natural Mahogany
SLC500DM -	Dark Mahogany
SLC500RM -	Red Mahogany

Rear View



FEATURES

TILT AND ROLL:™ The Lectern incorporates two recessed casters within the floor base. By tilting the cabinet rearward, the Lectern can be easily moved from location to location. Once the Lectern is returned to its vertical position, the Lectern is stationary and locked in position.

DC OPERATION: The Lectern may be operated on DC by using the optional rechargeable battery pack (see accessories). The battery is automatically recharged by the built-in recharger when the Lectern is operated on AC.

ACCESSORIES

M941M - Auxiliary Unidirectional Dynamic Microphone. Complete with 15ft (5 m) Cable and XLR male connector.

27/12 - 12 Volt sealed rechargeable battery pack. Lectern operates 5-6 hours on each charge. Mounts inside Lectern. Two required.

CV24 - 30ft. (10 m) Microphone Extension Cable complete with XLR connectors.

DIMENSIONAL DRAWINGS

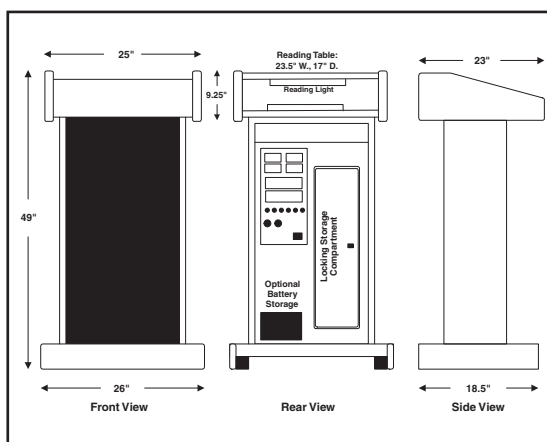

All PASO Lecterns and Cabinets are Handcrafted in the USA

Self-Standing Sound Powered Lecterns - Laminate Finish



SL 371 - 50 Watt Class **D** Digital Amplifier SOUND POWERED LECTERN Covers an audience of up to 1000

- ❑ HIGH INTELLIGIBILITY
- ❑ SOUND COLUMN SPEAKER SYSTEM
- ❑ UNIDIRECTIONAL DYNAMIC MICROPHONE
- ❑ OUTPUT FOR TAPE RECORDING DEVICE
- ❑ BUILT-IN SPEECH FILTER
- ❑ SCRATCH AND BURN RESISTANT FINISH
- ❑ DC OPERATION WITH OPTIONAL BATTERY

Streamlined Sound Lectern for voice reinforcement in Conference and Meeting Rooms, Auditoriums, Churches, Hotels, Motels, Schools, Clubs, Meeting Halls, etc. The handcrafted cabinet is durable and decorative, finished in either wood-grain walnut or light oak laminate. The powerful amplifier is combined with a high efficiency Sound Column Speaker System completely integrated within the Lectern's cabinet. The result is superb voice reproduction with a minimum of reverberation. Additional features include: Unidirectional Dynamic Microphone, shock-mount holder for the microphone, input for second microphone, output for tape or external PA system, output for external speaker, speech equalizer with switch, auxiliary input, volume and tone controls. The unit may operate on DC with the optional rechargeable battery. The battery is recharged while the lectern is used on AC.

AVAILABLE WITH OR WITHOUT SOUND SYSTEM (see below for models available)

MODELS WITH SOUND

SL371W - Walnut Finish
SL371K - Light Oak Finish

CABINETS ONLY

SL371CW - Walnut Finish
SL371CK - Light Oak Finish

SPECIFICATIONS

Power Output: 50 Watt RMS
Microphone: Unidirectional Dynamic
Microphone Holder: Anti-shock with Gooseneck
Speaker System: 4X 8" (200mm) Heavy Duty Speakers
Inputs: 1 Mic., 1 Aux.
Outputs: Tape/Line Out, External Speaker (4 Ohm)
Controls: Mic/Aux Volume, Speech Filter, Bass & Treble
Terminations: 1/4" Phono Jacks
Supply: 100-240V 50-60 Hz AC
DC: 24-28V DC with optional Battery
Power Consumption: AC 90 VA, DC 60 W
CABINETRY
Color Finish: Woodgrain Walnut or Light Oak

Material: High Density Wood Compound
Finish: Formica Laminate
Front Grill: Molded with Acoustic Cloth
Dimensions: 45" H., 21" W., 14½" D. (115 X 54 X 37 cm)
Net Weight: 65 Lbs (30 Kg)
SHIPPING INFORMATION
Shipping Weight: Carton 1: 67 Lbs (30.5 Kg)
Carton 2: 25 Lbs (11.5 Kg)
Dimensions: Carton 1: 47"X14"X23" (120X36X59 cm)
Carton 2: 25"X19"X6" (63.5X49X15 cm)
Carton Volume: Carton 1: 8.8³ Ft. (0.26³ m)
Carton 2: 1.7³ Ft. (0.047³ m)



ECO-Friendly
Green Product



Table-Top Sound Powered Lecterns - Laminate Finish

SL 370 - 50 Watt Class **D** Digital Amplifier SOUND POWERED LECTERN

- ❑ HIGH INTELLIGIBILITY
- ❑ UNIDIRECTIONAL DYNAMIC MICROPHONE
- ❑ OUTPUT FOR TAPE RECORDING DEVICE
- ❑ BUILT-IN SPEECH FILTER WITH SWITCH
- ❑ SCRATCH AND BURN RESISTANT FINISH
- ❑ DC OPERATION WITH OPTIONAL BATTERY

Economy model, self-contained, table-top Sound Lectern for sound reinforcement in Conference and Meeting Rooms, Schools, Motels, Private Clubs or wherever voice or music amplification is required. The lectern is acoustically engineered to provide clear reproduction with uniform coverage. The Unidirectional Dynamic Microphone is removable from its support on the lectern and can be used up to 15 ft. away from the lectern. A second microphone may be connected to the lectern. The tape output provides for direct connection to a recording device. The optional rechargeable battery permits the lectern to be used anywhere on DC power. The built-in battery recharger automatically recharges the battery while the lectern is operating on AC power.

AVAILABLE WITH OR WITHOUT SOUND SYSTEM (see below for models available)

MODELS WITH SOUND

SL370W - Walnut Finish
SL370K - Light Oak Finish

CABINETS ONLY

SL370CW - Walnut Finish
SL370CK - Light Oak Finish

SPECIFICATIONS

Power Output: 50 Watt RMS
Microphone: Unidirectional Dynamic
Microphone Holder: Anti-shock with Gooseneck
Speaker System: 8" (200mm) Heavy Duty Speaker
Inputs: 1 Mic., 1 Aux.
Outputs: Tape/Line Out, External Speaker (4 Ohm)
Controls: Mic/Aux Volume, Speech Filter, Bass & Treble
Supply: 100-240V 50-60 Hz AC

DC: 24-28V DC with optional Battery
Power Consumption: AC 90 VA, DC 60 W
Dimensions: 13¼" H., 21" W., 14½" D. (34 X 54 X 37 cm)
Net Weight: 38 lbs (18 Kg)
SHIPPING INFORMATION
Shipping Weight: 41 Lbs, (18.7 Kg)
Carton Dimensions: 24"X17"X17" (61X43X43 cm)
Carton Volume: 4.1³ Ft. (0.113³ m)



ECO-Friendly
Green Product



Self-Standing Sound Powered Lecterns - Laminate Finish



SL 372 - 50 Watt Class **D** Digital Amplifier SOUND POWERED LECTERN Covers an audience of up to 1500

- ☐ HAND POLISHED BRASS READING LIGHT
- ☐ SOUND COLUMN SPEAKER SYSTEM
- ☐ UNIDIRECTIONAL DYNAMIC MICROPHONE
- ☐ OUTPUT FOR TAPE RECORDING DEVICE
- ☐ RECESSED CASTERS FOR MOBILITY
- ☐ SCRATCH AND BURN RESISTANT FINISH
- ☐ DC OPERATION WITH OPTIONAL BATTERY

Streamlined Sound Column Lectern for voice reinforcement in Conference and Meeting Rooms, Auditoriums, Churches, Hotels, Motels, Schools, Clubs, Meeting Halls, etc. The handcrafted cabinet is durable and decorative, finished in either woodgrain walnut or light oak laminate with Reading Light. Two casters are recessed within the floor base for mobility. High efficiency Sound Column Speaker System provides high voice intelligibility with a Unidirectional Dynamic Microphone, shock-mount holder, input for second microphone, output for tape or external PA system, output for external speaker, speech equalizer with switch, auxiliary input, volume and tone controls. The unit may operate on DC with the optional rechargeable battery pack. The battery is recharged while the lectern is used on AC.

AVAILABLE WITH OR WITHOUT SOUND SYSTEM (see below for models available)

MODELS WITH SOUND

SL372W - Walnut Finish
SL372K - Light Oak Finish

CABINETS ONLY

SL372CW - Walnut Finish
SL372CK - Light Oak Finish

SPECIFICATIONS

Power Output: 50 Watt RMS
Microphone: Unidirectional Dynamic
Microphone Holder: Anti-shock with Gooseneck
Speaker System: 4X 8" (200mm) Heavy Duty Speakers
Inputs: 1 Mic., 1 Aux.
Outputs: Tape/Line Out, External Speaker (4 Ohm)
Controls: Mic/Aux Volume, Speech Filter, Bass & Treble
Terminations: 1/4" Phono Jacks
Supply: 100-240V 50-60 Hz AC
DC: 24-28V DC with optional Battery
Power Consumption: AC 90 VA, DC 60 W
CABINETRY
Color Finish: Woodgrain Walnut or Light Oak

Material: High Density Wood Compound
Finish: Formica Laminate
Reading Light: Hand Polished Solid Brass
Front Grill: Molded with Acoustic Cloth
Dimensions: 49" H., 21½" W., 18½" D. (125 X 55 X 47 cm)
Net Weight: 70 Lbs (32 Kg)
SHIPPING INFORMATION
Shipping Weight: Carton 1: 67 Lbs (30.5 Kg)
Carton 2: 40 Lbs (19 Kg)
Dimensions: Carton 1: 47"X14"X23" (120X36X59 cm)
Carton 2: 22½"X26"X14½" (58X68X37 cm)
Carton Volume: Carton 1: 8.83³ Ft. (0.26³ m) Carton 2: 5³ Ft. (0.15³ m)



ECO-Friendly
Green Product



Adjustable Height Sound Powered Lecterns - Laminate Finish

SL 381 - 50 Watt Class **D** Digital Amplifier SOUND POWERED LECTERN

- ☐ ADJUSTABLE HEIGHT FROM 49" TO 55"
- OTHER CHARACTERISTICS SAME AS
MODEL SL 372

The SL381 is a streamlined, manually adjustable, Sound Lectern for voice reinforcement in Conference and Meeting Rooms, Auditoriums, Churches, Hotels, Schools, Clubs, Meeting Halls, etc. The handcrafted all wood construction is both durable and decorative, finished in either woodgrain walnut or light oak laminate and a matching acoustic front grille. The total Lectern height is adjustable by means of a locking knob on the rear panel. The height can be varied from 49" to 55" (125 to 140 cm) to facilitate the use by persons of different height. A hand polished brass anti-glare reading light provides full illumination of the reading table. The powerful amplifier and the high efficiency Sound Column Speaker System provide superb voice reproduction and high intelligibility with a minimum of reverberation. Additional features include: Recessed casters for easy mobility, Unidirectional Dynamic Microphone, shock-mount holder for the microphone, input for second microphone, output for tape or external PA system, output for external speaker, speech equalizer with switch, auxiliary input, volume and tone controls.

DIMENSIONAL DRAWINGS

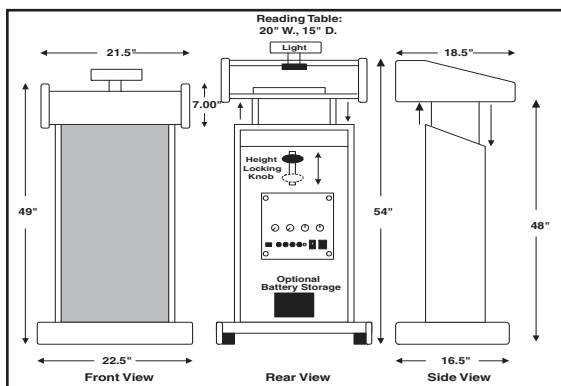

MODELS WITH SOUND

SL381W - Walnut Finish
SL381K - Light Oak Finish

CABINETS ONLY

SL381CW - Walnut Finish
SL381CK - Light Oak Finish

Net Weight: 84Lbs (39 Kg)
SHIPPING INFORMATION
Shipping Weight:
Carton 1: 70 Lbs (31.8 Kg)
Carton 2: 40 Lbs (19 Kg)
C. Dimensions: Carton 1:
47"X14"X23"
(120X36X59 cm)
Carton 2:
22½"X26½"X14½"
(58X68X37 cm)
Carton Volume: Carton 1:
8.83³ Ft.
(0.26³ m)
Carton 2: 5³ Ft. (0.15³ m)



ECO-Friendly
Green Product



All PASO Lecterns and Cabinets are Handcrafted in the USA

High Performance Unidirectional Electret & Dynamic Microphones

Push-to-talk, Desk Base Unidirectional Electret Microphone with integral push-to-talk switch and push-to-lock switch. The microphone is supplied with a 15-ft. shielded cable and is attached to the base by a female XLR Connector (the male XLR Connector is built-in the base of the Microphone). The cable consists of two conductors shielded for a balanced microphone input. Muting is provided by the VOX Circuit of the PASO Amplifier.



B 500EX Unidirectional Electret Push to Talk and Push to Lock Desk Base Microphone

- Low Impedance
- Push to Talk and Push to Lock Switches
- Die-Cast Base with Flexible Gooseneck

- Shock Mounted Gooseneck and Element
- Built-in XLR Male Connector
- Furnished with 15 cable and XLR (at MIC end)

Phantom Power required - 12 to 48 Volt

Element:	Electret
Frequency Response:	60 - 14,000 Hz
Polar Pattern:	Cardioid
Impedance:	250 ohm
Output Level at 1Khz:	
Power Level:	-57 db (0 db=1 mw/10 mbar)
Open Circuit Voltage:	-77 db .13 mV (0 db=1 V/mbar)
Talk Switches:	Push to talk Illuminated Push to Lock Illuminated
Base:	Heavy Duty Die-Cast
Finish:	Dark Grey and Silver
Dimensions:	Base: 5" W., 6" D., Tapered, 2" H. (127 X 153 X 51 mm)
Gooseneck:	Removable Black with XLR
Length:	18" (458 mm)
Net Weight:	1.7Lbs (0.8 Kg)



A desirable sound system begins with a good microphone. Paso unidirectional dynamic microphones' frequency response has been tailored to provide the best possible reproduction regardless of environmental noise, undesirable acoustics and microphone placement. Most Paso "Handlers" series microphones feature a rugged die-cast zinc alloy enclosure. This mechanical solution insures high tensile strength and great resistance to shock. The dynamic element is then surrounded by a heavy-duty woven wire mesh grille and further protected by a foam "pop" and windscreen. Finally the exclusive non-reflecting scratch and stain resistant finish is electroplated on the enclosure for long lasting protection and beauty.

Model Configurations

M911F -With Female Connector*

M911M - With Male Connector*

M911X - Without Connector

* 3 pin audio connector attached at equipment end

A general purpose Unidirectional Dynamic Microphone that offers good quality in a handsomely designed enclosure. The high sensitivity and high output cartridge is shock mounted to minimize handling noise. Specifically designed for voice applications the uni pattern is particularly useful for cancelling acoustic feedback and background noise. The smooth response is tailored to provide a crisp and clear reproduction without annoying boominess. Other characteristics include rugged wiremesh wind screen, On Off switch, non-reflecting scratch resistant black electroplated finish, standard mount stand holder, 15 ft. cable and protective carrying case.



High Output

M911

Unidirectional Dynamic General Purpose

Element:	Dynamic Shock Mounted
Frequency Response:	60 - 14,000 Hz
Polar Pattern:	Cardioid
Impedance:	250 ohm
Output Level:	At 1,000 Hz
Power Level:	-55 db (0 db=1 mw/10 mbar)
Open Circuit Voltage:	-74 db .20 mV (0 db=1 V/mbar)
Switch:	On- Off
Case:	Zinc Diecast
Finish:	Matte Black
Dimensions:	6.5" (165 mm) Long 2.15" (54 mm) head diam.
Accessories Included:	Tapered Stand Holder 15 Ft. (5 m) Cable, Carrying Case
Net Weight:	11 oz (312 grams)

Unidirectional Dynamic General Purpose Public Address

Element:	Dynamic Shock Mounted
Frequency Response:	60 - 15,000 Hz
Polar Pattern:	Cardioid
Impedance:	250 ohm
Output Level:	At 1,000 Hz
Power Level:	-55 db (0 db=1 mw/10 mbar)
Open Circuit Voltage:	-74 db .20 mV (0 db=1 V/mbar)
Switch:	On- Off
Case:	Zinc Diecast
Finish:	Matte Black
Dimensions:	6.5" (165 mm) long 1.6" (40 mm) head diameter
Accessories Included:	Stand Holder 15 Ft. (5 m) Cable, Carrying Case
Net Weight:	11 oz (312 grams)

A general purpose, Unidirectional Dynamic Microphone particularly suited for sound reinforcement and recording. The rugged high sensitivity and high output cartridge is shock mounted to minimize handling noise. Specifically designed for voice applications the uni pattern is particularly useful for cancelling acoustic feedback and unwanted background noise. Other characteristics include metal wind screen, On Off switch, matte black non-reflecting scratch and stain resistant electroplated finish, standard mount stand holder and a 15 ft. detachable cable.

Model Configurations

M921F -With Female Connector*

M921M - With Male Connector*

M921X - Without Connector

* 3 pin audio connector attached at equipment end

High Output

M921



High Performance Unidirectional Dynamic Microphones



Model Configurations

M941F -With Female Connector*

M941M - With Male Connector*

M941X - Without Connector

* 3 pin audio connector attached at equipment end

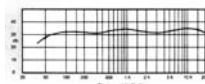

A Super Grade Unidirectional Dynamic Microphone that is both rugged and handsomely styled. A doubly redundant, highly damped suspension system completely isolates the cartridge from the outer case, greatly minimizing handling noise. The Hypercardioid pattern prevents acoustic feedback in difficult applications. Front to back rejection exceeds 25 db at 1 KHz. permitting greater usable output with less "howling problems" and background noise. The high frequency response characteristics add the right amount of "brightness" for a realistic "presence effect". Other features include On-Off switch, black non-reflecting scratch resistant electroplated finish, anti-shock holder, 15-ft. cable and carrying case.

Hypercardioid

M941

Unidirectional Dynamic Super Grade, Vocal, Stage

Element:	Dynamic Shock Mounted
Frequency Response:	50 - 17,000 Hz
Polar Pattern:	Hypercardioid
Impedance:	250 ohm
Output Level:	At 1,000 Hz
Power Level:	-57 db (0 db=1 mw/10 mbar)
Open Circuit Voltage:	-77 db .013 Mv (0 db=1 V/mbar)
Switch:	On- Off
Case:	Zinc Diecast
Finish:	Matte Black
Dimensions:	7" (178 mm) long 2" (54 mm) head diameter
Accessories Included:	Tapered Stand Holder 5/-27 15 Ft. (5 m) Cable, Carrying Case
Net Weight:	12.2 oz (315 grams)

Element:	Dynamic Shock Mounted
Frequency Response:	50 - 18,000 Hz
Polar Pattern:	Hypercardioid
Impedance:	250 ohm
Output Level:	At 1,000 Hz
Power Level:	-57 db (0 db=1 mw/10 mbar)
Open Circuit Voltage:	-77 db 0.13 Mv (0 db=1 V/mbar)
Switch:	On- Off
Case:	Zinc Diecast
Finish:	Matte Black
Dimensions:	6.5" (165 mm) long, 2.15" (54 mm) head diameter
Accessories Included:	Tapered Stand Holder 5/8-27 15 Ft. (5 m) Cable, Carrying Case
Net Weight:	13.5 oz (348 grams)

Hypercardioid

M951

Unidirectional Dynamic Professional, Studio, Stage, Vocal

Model Configurations

M951F -With Female Connector*

M951M - With Male Connector*

M951X - Without Connector

* 3 pin audio connector attached at equipment end



Produced for those who need a hand-held, high performance professional microphone. Big bass sound for close "miking", wide frequency response for crisp sound, rugged design, built-in pop filter and high output. A doubly redundant, highly damped suspension system completely isolates the cartridge from the outer case, greatly minimizing handling noise. Hypercardioid design provides front to back rejection greater than 25 db at 1 KHz. permitting higher usable output with less "howling problems" and background noise. Other features include high efficiency anti-pop filter, On-Off switch, black non-reflecting scratch resistant electroplated finish, stand holder, 15 ft. detachable cable and carrying case.

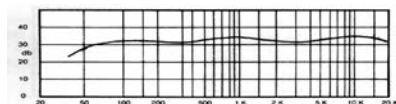

Ultracardioid

M960

Neodymium Ultracardioid Dynamic Professional, Studio, Stage, Vocal

Model Configurations

M960F -With Female Connector*

M960M - With Male Connector*

M960X - Without Connector

* 3 pin audio connector attached at equipment end

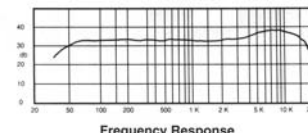

Element:	Dynamic Shock Mounted
Magnet:	Neodymium with almi-chromate coating
Frequency Response:	45-19,000 Hz
Polar Pattern:	Ultracardioid
Impedance:	250 ohm nominal
Output Level:	At 1,000 Hz (1 Pascal= 10 dynes/cm ² = 10 mbar)
Power Level:	-51 db (0 db=1 mW/Pascal)
Open Circuit Voltage:	2.9 Mv/Pascal
Phasing:	Positive pressure on diaphragm produces a positive voltage on Pin 2 of XLR connector
Enclosure:	Heavy-Duty Zinc Die-Cast
Finish:	Leather-Touch TM Black
Dimensions:	172 mm (6.75") long 55 mm (2.2") head diam.
Output Connector:	Integral 3 pin XLRM gold plated
Net Weight:	310 grams (11 Oz) less cable

- ☐ Neodymium Magnet with almi-chromate coating
- ☐ Ultracardioid Pattern
- ☐ Shock Mount Element
- ☐ High Output Level
- ☐ Leather-Touch non-reflectant Finish
- ☐ Dual Wind Screen
- ☐ Heavy-Duty Zinc Die-Cast Enclosure

- ☐ Rugged Outer Screen Mesh
- ☐ Wide Frequency Response
- ☐ High Unidirectional Sensitivity
- ☐ High anti-pop Capability
- ☐ Integral Gold Plated Connector
- ☐ Patented Shock-Mount Stand Holder
- ☐ Detachable 15 ft. Cable with XLR
- ☐ Protective Carrying Case included

ACCESSORIES



WMP-3F - Female XLR Connector on a wall mount plate. Standard single gang plate. Connector: XLR Female with lock. Brushed stainless steel. Plate Size: 4½" H., 2¾" W., 1¼" D. (115X70X32 mm) Complete with mounting screws.



S1 - Adjustable microphone holder. Accepts microphones with up to 1" (2.5 cm) diameter. Standard threaded brass insert. Black finish.



S12 - Anti-shock microphone holder. Drastically minimizes stand handling noise. Accepts microphones with up to 1¼" (3.1 cm) diameter. Standard threaded brass insert. Black finish.

Wide Range Dual Cone



SP570 with 25/70V Transformer

Wide Range Dual Cone Speaker SP500 - 8" Dual Cone Speaker Only

Power Handling:	10 Watt RMS
Music Power Max.:	15 Watt
Frequency Response:	50 - 18 Khz
Sensitivity:	96 db at 1 W - 1 Meter
Speaker Type:	8" (200 mm) Dual Cone
Magnet:	5.4 Oz (153 g) Ceramic
Flux Density:	9,600 Gauss
Impedance:	8 ohm
Net Weight Each:	1.2 Lbs (0.6 Kg)
Standard Packaging:	12 Pcs per Carton

SP570 - Speaker with 25/70 V Transf.

Speaker assembly. 8" Wide Range, Dual Cone Speaker with pre-mounted 5 Watt, 25 Volt and 70 Volt Line Transformer.

Same as SP500 Transformer Mounted
Power Taps:

25 Volt	5-2.5-1.25-0.625 Watt
70 Volt	5-2.5-1.25-0.625 Watt

Net Weight Each:	1.7 Lbs (0.8 Kg)
Standard Packaging:	12 Pcs per Carton
Gross Carton Weight:	24.2 Lbs (11 Kg)

Wide Range High Efficiency



SP1070 with 25/70V Transformer

Wide Range Dual Cone Speaker SP1000 - 8" Dual Cone Speaker Only

Power Handling:	15 Watt RMS
Music Power Max.:	25 Watt
Frequency Response:	50 - 18 Khz
Sensitivity:	97 db at 1 W - 1 Meter
Speaker Type:	8" (200 mm) Dual Cone
Magnet:	10 Oz (285 g) Ceramic
Flux Density:	10,700 Gauss
Impedance:	8 ohm
Net Weight Each:	1.7 Lbs (0.8 Kg)
Standard Packaging:	12 Pcs per Carton

SP1070 - Speaker with 25/70 V Transf.

Speaker assembly. 8" Wide Range, Dual Cone Speaker with pre-mounted 5 Watt, 25 Volt and 70 Volt Line Transformer.

Same as SP1000 Transformer Mounted
Power Taps:

25 Volt	5-2.5-1.25-0.625 Watt
70 Volt	5-2.5-1.25-0.625 Watt

Net Weight Each:	2.2 Lbs (1.0 Kg)
Standard Packaging:	12 Pcs per Carton
Gross Carton Weight:	29.7 Lbs (13.5 Kg)

Full Range Coaxial

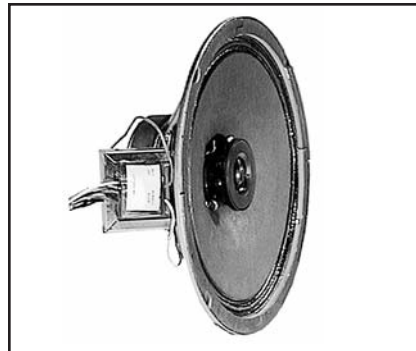

SP810CXT with 25/70V Transformer

2 Way Coaxial Speaker SP810CX - 8" Coaxial, Speaker Only

Power Handling:	20 Watt RMS
Music Power Max.:	30 Watt
Frequency Response:	40 - 20 Khz
Sensitivity:	98 db at 1 W - 1 Meter
Speaker Type:	8" (200 mm) Coaxial
Tweeter:	Polypropylene
Magnet:	10 Oz (285 g) Ceramic
Flux Density:	10,700 Gauss
Impedance:	8 ohm
Net Weight Each:	2.5 Lbs (1.3 Kg)
Standard Packaging:	12 Pcs per Carton

SP810CXT - Spkr with 25/70 V Transf.

Speaker assembly. 8" Full Range, Coaxial Speaker with pre-mounted 10 Watt, 25 Volt and 70 Volt Line Transformer.

Same as SP810CX Transformer Mounted
Power Taps:

25 Volt	10-5-2.5-1.25 Watt
70 Volt	10-5-2.5-1.25 Watt

Net Weight Each:	2.8 Lbs (1.3 Kg)
Standard Packaging:	12 Pcs per Carton
Gross Carton Weight:	34.75 Lbs (15.8 Kg)

Line Transformer T2570/10 - 10 Watt, 25/70V



Wide response for background/foreground music applications. Low insertion loss. High quality. Colored Wire Pigtail.

Power Handling:	10 Watt
Line Voltage:	25 Volt and 70.7 Volt
Power Taps:	
25 Volt:	10 - 5 - 2.5 - 1.25 W
70 Volt:	10 - 5 - 2.5 - 1.25 W
Secondary Impedance:	8 ohm
Termination:	Stripped Wire Pigtail
Insertion Loss:	1.0 db

Ceiling Speaker Back Box ERD8 - Closed Steel Enclosure



Ceiling loudspeaker back box. Heavy-gauge steel construction. Complete with mounting straps and J-nuts for attaching Ceiling Baffles. Knockouts for armored cable mount. Integral Polymer damper. UL Listed

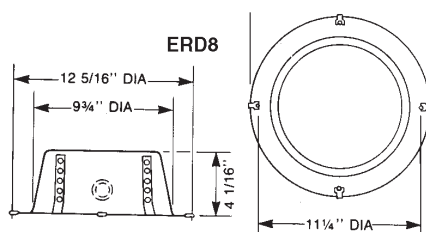

Ceiling Speaker Tile Bridge SSB3 - Tile Bridge Assembly

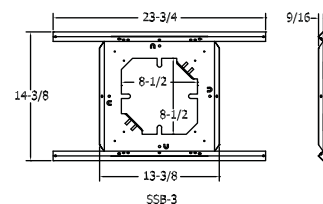

Ceiling loudspeaker tile bridge. Permits mounting of ceiling speaker over suspended ceiling frame. Prevents sagging of tile by supporting speaker weight over frame.



Ceiling Speaker Assemblies - Line Attenuators Accessories

Wide Range Dual Cone



C15TST with 25/70V Transformer

Wide Range Dual Cone Speaker
C15TST - 8" Dual Cone Speaker, 5.4 Oz Magnet with 25/70 Volt Transformer and White Steel Baffle

Recessed mount Ceiling Speaker assembly. 8" Wide Range, Dual Cone Speaker with Line Transformer. White Steel Baffle. Supplied with mounting hardware.

Assembly Model No.: C15TST
 Power Handling: 10 Watt RMS
 Music Power Max.: 15 Watt
 Frequency Response: 50 - 18 KHz
 Sensitivity: 96 db at 1 W - 1 Meter
 Speaker Model: SP570
 Speaker Type: 8" (200 mm) Dual Cone
 Magnet: 5.4 Oz (153 g) Ceramic
 Flux Density: 9,600 Gauss
 Line Transformer: 5 Watt - 25/70 Volt
 Power Taps: 5-2.5-1.25 Watt
 Dimensions: 13" (330 mm) Diameter
 3.5" (89 mm) Deep
 Net Weight: 2.4 Lbs (1.1 Kg)
 Baffle Finish: White
 Baffle Material: Steel
 Standard Packaging: Individually Boxed
 Master Carton: 12 Pcs per Carton

Wide Range High Efficiency



C16TST with 25/70V Transformer

Wide Range Dual Cone Speaker
C16TST - 8" Dual Cone Speaker, 10 Oz Magnet with 25/70 Volt Transformer and White Steel Baffle

Recessed mount Ceiling Speaker assembly. 8" Wide Range, Dual Cone Speaker with Line Transformer. White Steel Baffle. Supplied with mounting hardware.

Assembly Model No.: C16TST
 Power Handling: 15 Watt RMS
 Music Power Max.: 25 Watt
 Frequency Response: 50 - 18 KHz
 Sensitivity: 97 db at 1 W - 1 Meter
 Speaker Model: SP1070
 Speaker Type: 8" (200 mm) Dual Cone
 Magnet: 10 Oz (285 g) Ceramic
 Flux Density: 10,700 Gauss
 Line Transformer: 5 Watt - 25/70 Volt
 Power Taps: 5-2.5-1.25 Watt
 Dimensions: 13" (330 mm) Diameter
 3.5" (89 mm) Deep
 Net Weight: 3 Lbs (1.5 Kg)
 Baffle Finish: White
 Baffle Material: Steel
 Standard Packaging: Individually Boxed
 Master Carton: 12 Pcs per Carton

Full Range Coaxial



C20CXTS with 25/70V Transformer

Full Range Coaxial Speaker
C20CXTS - 8" Coaxial Speaker, 10 Oz Magnet with 25/70 Volt Transformer and White Steel Baffle

Recessed mount Ceiling Speaker assembly. 8" Full Range, 2 Way Coaxial Speaker with Tweeter and with Line Transformer. White Steel Baffle. Supplied with mounting hardware.

Assembly Model No.: C20CXTS
 Power Handling: 20 Watt RMS
 Music Power Max.: 30 Watt
 Frequency Response: 40 - 20 KHz
 Sensitivity: 98 db at 1 W - 1 Meter
 Speaker Model: SP810CXT
 Speaker Type: 8" (200 mm) Dual Cone
 Tweeter: Polypropylene
 Magnet: 10 Oz (285 g) Ceramic
 Flux Density: 10,700 Gauss
 Line Transformer: 10 Watt - 25/70 Volt
 Power Taps: 10-5-2.5-1.25 Watt
 Dimensions: 13" (330 mm) Diameter
 3.5" (89 mm) Deep
 Net Weight: 4 Lbs (1.8 Kg)
 Baffle Finish: White
 Baffle Material: Steel
 Standard Packaging: Individually Boxed
 Master Carton: 12 Pcs per Carton

Speaker Line Attenuators



VC20



VC100

GENERAL PURPOSE AUTO TRANSFORMER ATTENUATORS - High quality 20 and 100 watt auto transformer series provides wide frequency response, low insertion loss and reliable performance for volume control application in 25 Volt and 70 Volt systems. Attenuation rate of 3 db steps is accomplished with a non-shorting rotary switch with ten steps plus positive off position. Contacts are silver plated for noise-free operation. Selection includes one or two gang sized models with stainless steel plate, stamped and filled dial scale and skirted black knob. Available in mono configuration only.

Model No.	Power Rating	Positions	Attenuation Per Step	Total Attenuation	Insertion Loss	Mounting Size
VC20	20 Watt	10-Off	3 db	30 db	.4 db	1 Gang
VC100	100 Watt	10-Off	3 db	30 db	.6 db	2 Gang

DIMENSIONAL SPECIFICATIONS

Model	A	B	C	D	E
VC20	4½" (114mm)	2-1/8" (54 mm)	1½" (38mm)	2¾" (70 mm)	1¾" (45 mm)
VC100	4½" (114 MM)	2-5/8" (67 mm)	2" (51 mm)	4½" (116 mm)	2½" (64 mm)

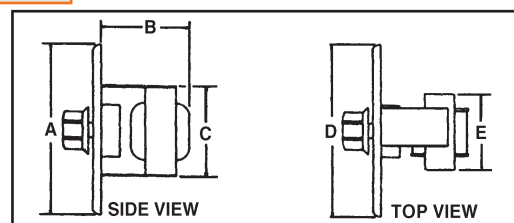

30 Watt Reflex Rectangle Speaker - 25V - 70V - 100V Transformer

Paging and talk back reflex speakers for low to medium power output levels in paging, emergency alarm, protective signalling, intercom systems, public address and mobile applications both indoor or outdoor. The speakers employ a new high compression driver system that provides high efficiency, peak-free response and superior sound penetration and range. The wide-angle design of the rectangle type further improves the acoustic efficiency by concentrating more power where it is needed. High impact molded construction is virtually immune to extremes in weather conditions, deterioration and abuse. The exclusive dual swivel support of the model TR30/T permits continuous horizontal and vertical orientation of the speaker. Superior sound penetration. Rugged construction. Weatherproof.



Model TR30T

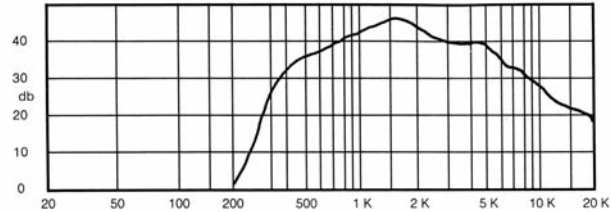

Frequency in Hertz

SPECIFICATIONS

Power Handling:	30 Watts continuous
Frequency Response:	275 to 14,000Hz (nominal)
Power Taps 100 Volt:	30, 15, 7.7, 4.0 Watt
Power Taps 70 Volt:	30, 15, 7.5, 3.7, 1.8 Watt
Power Taps 25 Volt:	15, 7.5, 3.7, 1.8 Watt
Power Taps Selector:	Rotary Screwdriver adjustable
Talk Back Impedance:	45 ohm (Tap No. 7)
Dispersion Angle:	120° Hor., 60° Ver.
Sensitivity (SPL):	125 db at 30 watt (peak) 120 db at 30 Watt at 1 meter 106 db at 1 meter, 1 Watt
Sensitivity as Microphone:	-23 dbm
Horn Material:	High Impact ABS
Driver Housing Material:	Zinc Die-Cast
Terminals:	Screw Type with cover
Dimensions:	11"W 6 3/4"H 12 3/4"D 280 X 172 X 324 mm
Color Finish:	Beige
Net Weight:	5.5 lbs (2.5 Kg)

30 Watt, General Purpose, Rectangle Speaker with 25V-70V-100V Transformer and Swivel Mounting Support

A rectangular double reentrant paging and talk-back speaker engineered for paging, public address, indoor or outdoor emergency alarm, protective signalling and intercom system applications. It is primarily recommended for use in indoor or outdoor areas where maximum speech intelligibility and sound coverage are required. It incorporates a high efficiency driver with a new high compression acoustic coupling system, a heavier narrow gap magnetic structure and a precision self-aligning driver unit assembly. Efficiency and effective sound coverage have been greatly improved for even better intelligibility and voice penetration. High impact ABS construction with die-cast driver and transformer housing. Built-in 25 Volt, 70 Volt and 100 Volt line transformer with rotary power tap selector. Armored cable adapter is optional.

ACCESSORIES

ACB30 - Armored Cable Bracket. Attaches on to Speaker Input Terminals Housing.

MEGAVOICE® - Power Megaphone



The Paso TA25W is a ruggedly constructed, Power Megaphone. The powerful amplifier utilizes a reflex horn speaker to provide a narrow sound dispersion with greater power concentration, sound penetration and effective range. It may be used for indoors applications or outdoors in any weather. The reduced dimensions of the Megaphone permit greater mobility and freedom of movement. Virtually indestructible, the non-corrosive, shockproof construction will withstand the abuse encountered in portable use. A hand carrying strap is provided. Operates on eight size C batteries. Alkaline batteries recommended. Batteries not included.

25 Watt Power Megaphone with Signal Alarm, 800 Yard Range TA25W

Power Output:	25 Watt
Microphone:	Unidirectional Dynamic
Speaker System:	Reflex Horn
Signal Alarm:	Whistle Tone
Controls:	Volume, Hand-grip On-Off Switch, Signal Alarm Switch
Supply:	8 Size C Batteries
Battery Life:	Approx.. 15 Hours Alkaline Batt.
Carrying Strap:	Furnished
Color Finish:	White Bell with Navy Blue Body
Dimensions:	Bell 9" (23 cm), 15" (38 cm) L.
Net Weight:	3.5 Lbs (1.6 Kg) less batteries
Shipping Weight:	Carton 1: 5 Lbs (2.3 Kg)
Dimensions: Carton:	1: 17"X10"X10" (44X26X26 cm)
Carton Volume:	Carton 1: 0.99³ Ft. (0.028³ m)



- RUGGED HIGH-IMPACT CONSTRUCTION
- UNIDIRECTIONAL DYNAMIC MICROPHONE
- BUILT-IN SIGNAL ALARM
- HIGH EFFICIENCY REFLEX SPEAKER SYSTEM
- OPERATES WITH SELF-CONTAINED BATTERIES
- COMPLETE WITH CARRYING STRAP

40 WATT - 2-Way Wide Range Indoor/Outdoor Waterproof Speaker System - Ideal for Music and Paging RUGGED ABS CONSTRUCTION - STAINLESS STEEL HARDWARE AND GRILL CAN OPERATE OUTDOORS INDEFINITELY

C55DMSTW - 40 WATT - 25-70-100 V WATERPROOF SPEAKER SYSTEM - COLOR FINISH WHITE

A waterproof speaker system created specifically for background or foreground music systems and paging. The watertight design allows extended use indoors in environments experiencing high humidity or the presence of moisture such as Ice Skating Rinks, Sporting Arenas, Indoor Pools, Kitchens, Manufacturing Facilities, etc. or outdoors, the speaker can be used literally everywhere, on walls, poles, roofs, ground, etc.. The wide frequency response and the acoustically balanced enclosure provide superb music reproduction and high efficiency. It is highly recommended for Patio Speaker applications as an outdoor speaker for Restaurants, Gardens, Around Pools, Shopping Malls, Marinas, etc. This ruggedly constructed, fully damped speaker utilizes a heavy-duty, fiberglass, acoustic suspension transducer and a hard polymer dome tweeter for long life and constant performance with time. Ergonomically engineered, the C55DMST can be rapidly mounted on ceiling, wall or shelf, etc. with the mounting bracket provided or can be used in arrays. Dynamically styled the enclosure is finished in designer Off-White with a metal mesh speaker grille. Supplied with an adjustable sliding mounting bracket and vandal resistant hardware. Built-in 25 - 70 - 100 Volt Line Transformer.



Specifications

Power Output:	40 Watt RMS long term
Continuous Program:	80 Watt Music
Frequency Response:	80 - 22,000 Hz
Applications:	Waterproof Outdoor use, long term Music Reproduction and Paging Integral, Wide Frequency Response
Line Transformer:	
Power Taps:	
25 Volt	40 - 10 - 5 - 2.5 - 1.2 - 0.7 Watt
70 Volt	40 - 20 - 10 - 5 - 2.5 Watt
Dispersion Angle:	70°
Sound Pressure Level:	110 db Anechoic Environment 4' on axis at rated output 95 db 1 Watt/1 Meter on axis
Transducer Size:	6" Heavy Duty
Type:	High Efficiency, Fiberglass with Polyester Urethane Cone Surround 1" Neodymium Magnet Hard Polymer Dome
Tweeter:	
Housing Material:	ABS - meets UL 94 VO
Speaker Grille;	High Impact Stainless Steel
Termination:	Multicolor Wire Pigtail
Mounting:	Adjustable Bracket Supplied
Hardware:	Stainless Steel Vandal Resistant
Dimensions:	8" W., 8½" D. (204 X 216 mm)
Net Weight:	6 Lb. (2.75 Kg)

Dimensional Drawings

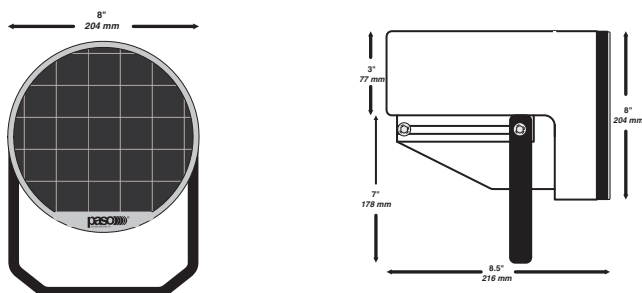

UL94VO



- Waterproof for Outdoor Applications
- Foreground/Background Music Systems
- High Quality Music Reproduction
- Sound Reinforcement Systems
- Environmental Music Systems
- High Efficiency Music or Paging
- Can be Used Outdoors Indefinitely
- 2-Way Air Suspension, Wide Range System
- Rugged Fiberglass Transducer with Tweeter
- Dual Gasket Watertight Construction

- High Impact Stainless Steel Grille Protector
- Built-in 25V-70V Multi-Tap Line Transformer
- Single Cable Multi-Wire Tap Selector
- Controlled Sound Radiation Pattern
- Adjustable Mounting Bracket Supplied
- Vandal Resistant Stainless Steel Hardware
- Neodymium Magnet Hard Polymer Dome Tweeter
- Wide Frequency Response Transformer
- Available In White
- Rugged ABS UL 94VO Enclosure

BETTER SOUND



Innovation through Technology since 1931



PASO SOUND PRODUCTS, INC.
4750F GOER DRIVE
CHARLESTON, SOUTH CAROLINA 29406-6511 USA
Phone: 843 308 9005 - Fax: 843 308 0904
EMAIL: info@pasosound.com - URL: www.pasosound.com
FORM PF 240 RV 1.0 Printed in USA

AUTHORIZED DISTRIBUTOR

