

**HHC**

Helmet, Head and Chest Light

## Owner's Manual

P/N 199-200 HHC Light, Black

P/N 199-201 HHC Light, ODG

Please read the below before using your HHC as it relays beneficial operating and safety information.

### Table of Contents

#### 1. INTRODUCTION

- a. Overview
- b. Key Features
- c. Physical Characteristics
- d. Electrical Characteristics
- e. Product Durability, Environmental Constraints & Certifications

#### 2. SETUP

- a. Itemized Description
- b. Unpacking the HHC
- c. Batteries: Type & Battery Life
- d. Battery Installation & Replacement
- e. Setup HHC for Use

#### 3. OPERATION

- a. Operational Modes
- b. Performance/Battery Life

#### 4. MAINTENANCE

#### 5. ACCESSORIES & REPLACEMENT PARTS

#### 6. WARNINGS

#### 7. WARRANTY AND CUSTOMER CARE

- a. HHC Warranty

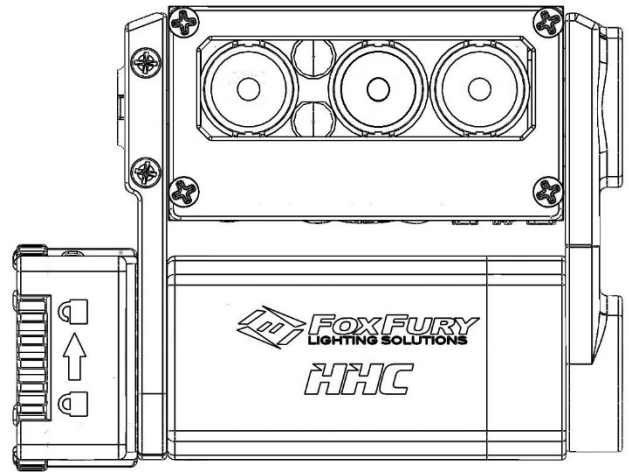
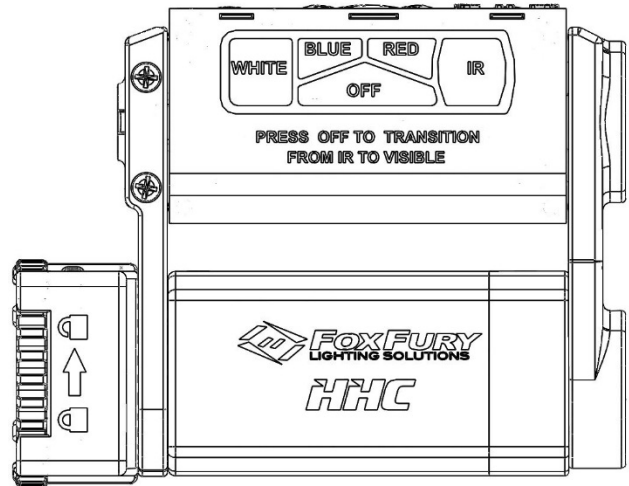

## 1. INTRODUCTION

### Overview

The multi-purpose HHC is a compact and powerful LED light which has the ability to be worn on the Helmet, Head or Chest Light. It can be worn with a C-Clamp Mount, Molle Mount, or Headlamp Mount with Elastic Strap. 1 White, 1 Blue, 1 Red and 2 IR LED lights each also have 4 intensity modes. Each color has its own switch, and each color retains the mode in memory. One (1) single AA or one (1) CR123 battery will drive the waterproof unit.

### Key Features:

- Individually, rotations can take place as follow:
  - Main unit can rotate 360° against clamp
  - Light Head holder can rotate 120°
  - Light Head can rotate 90°
- Operational Modes
  - 4 Intensity modes
  - 2 Blinking modes
- Identification Friend or Foe – IFF

### Physical & Electrical Characteristics:

- Nylon 66 body
- Weight – 4.4 oz / 125g
- Dimensions:

Width	3.2" / 82mm
Depth	1.3" / 32mm
Height	2.6" / 65mm

- Beam –
  - Peak Beam Intensity 866 cd with White LED & CR123 battery
  - Maximum Beam Distance: 196 ft / 60m
- Light Head-
  - One (1) White LED (color temperature: 5800 K)
  - One (1) Blue 460nm LED
  - One (1) Red 625nm LED
  - Two (2) Infrared 940nm LEDs
- Light Intensity Range -

	Lumens
Maximum	82
Minimum	10

### Product Durability, Environmental Constraints & Certifications:

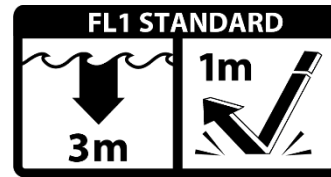

CE  
CE-EMC  
IPX-7

- Meets NFPA 1971-2007 Fire Resistant Requirements: 500°F / 260°C for 30 minutes
- Operates in temperatures varying from 14°F (-10°C) to 300°F (149°C)

## 2. SETUP

### Itemized Description

- A. Main body
- B. Swiveling Light Head
- C. Battery knob
- D. Switch Panel
- E. LED Window
- F. 360° rotation coupling adapter

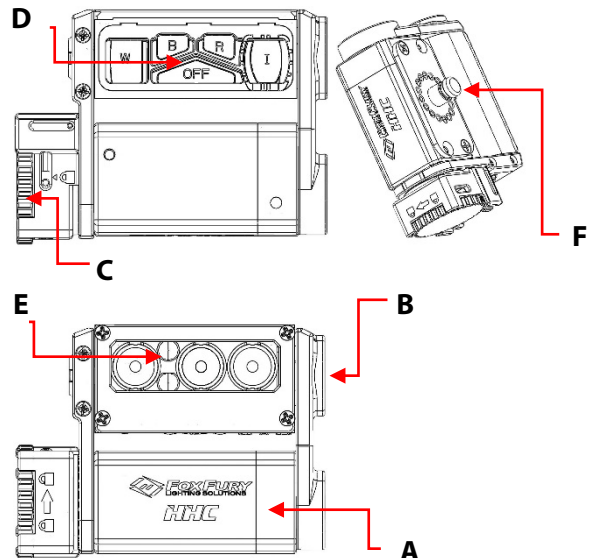



### Unpacking the HHC:

\*Make sure the following is present:  
HHC Blinker

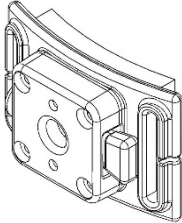
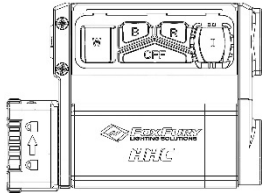

**Headlamp Mount & Elastic Strap**

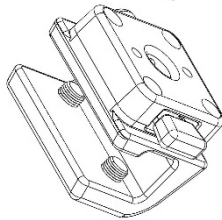

**C-Clamp Mount**

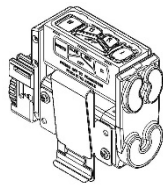

**Molle Mount**

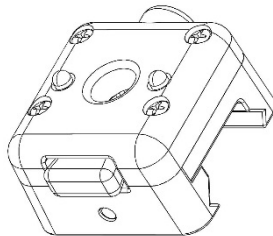

**Picatinny Mount**

- Hex Wrench
- Owner's Manual

### Batteries:

The HHC Light accepts either one (1) AA or one (1) CR123A battery.

### Performance/Battery Life:

Approximate battery life is as follows, according to LED color:

### NOTE:

Battery life may vary according to selected mode, battery quality, and prevailing ambient conditions.

Mode	White Light	Red & Blue Light	Infrared Light
1	4 hrs	4 hrs	6 hrs
2	6 hrs	6 hrs	9 hrs
3	9 hrs	9 hrs	15 hrs
4	14 hrs	14 hrs	24 hrs
5	16 hrs	16 hrs	18 hrs
6	16 hrs	16 hrs	18 hrs

### Battery Installation & Replacement

All HHC follow the below:

1. Rotate knob counter clockwise until it stops, and pull it away from the housing. Then rotate lid up to remove/insert battery

Rotate battery knob to unlock

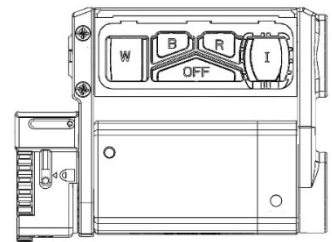

Pull battery door out along axis to end of the guide.

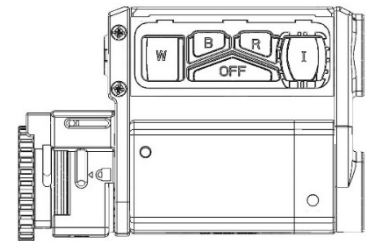

Battery door can be rotated upwards for access to battery.

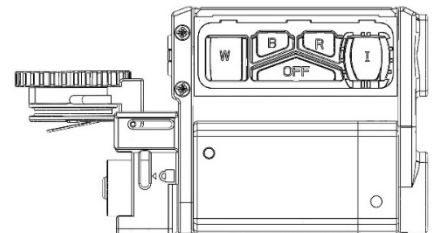

2. Install one (1) battery, noting correct polarity indicated inside the Cap.

3. Close the cap and rotate knob clockwise until securely closed. You will notice the locking pin against the edge.

### Setup HHC for Use:

#### 360° rotating coupling adapter

*First ensure the coupling adapter is on the correct side for use with mounts*

For the C-Clamp and Picatinny

Note HHC logo orientation

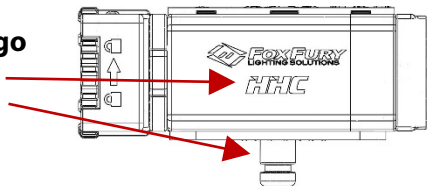

For Headlamp

Note HHC logo orientation

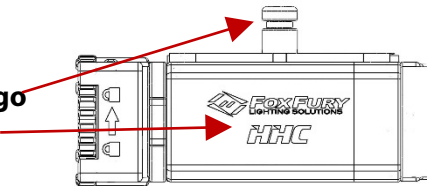

*Installing all mounts that use the 360° rotating coupling adapter.*

(C-clamp, Picatinny, Headlamp)

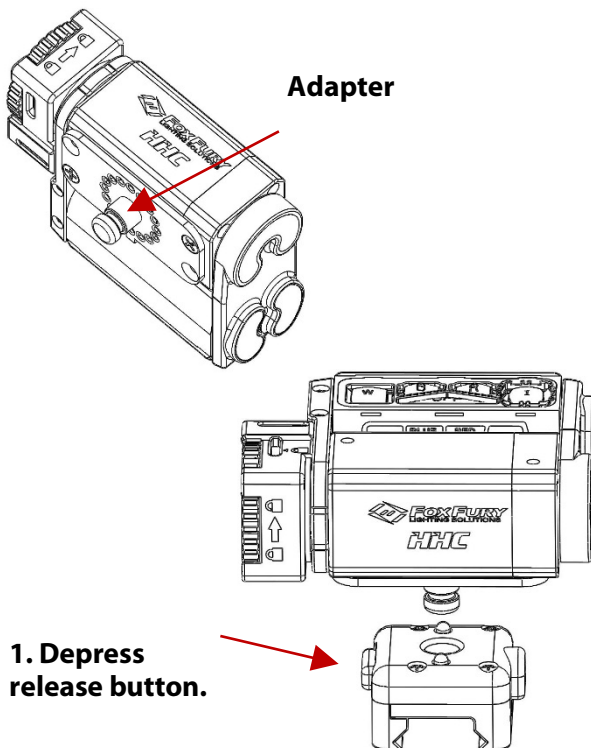

1. Depress release button.

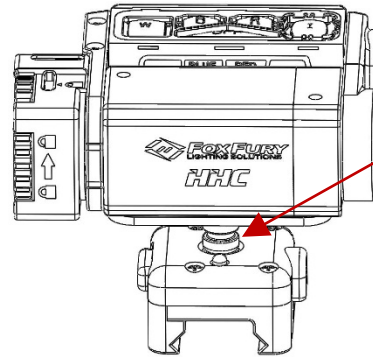

2. While holding the release button align the coupling adapter with the opening in the mount and the insert.

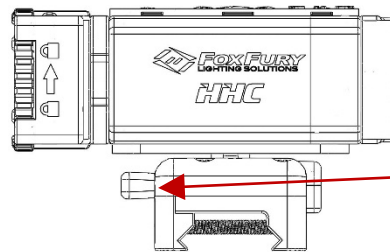

3. When the locking pin clears the notch on the coupler press firmly from bottom of mount until a click is heard and release button. When the release button is full extended the mount is secure.

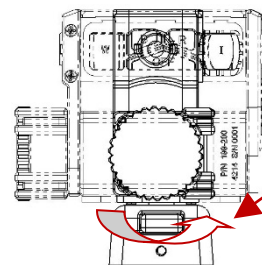

360° rotation on the coupling adapter.

### C-Clamp Mount

1. Loosen set screws. Align the C-Clamp on the lip of helmet. While holding C-clamp tighten the set screws on using the Hex key provided

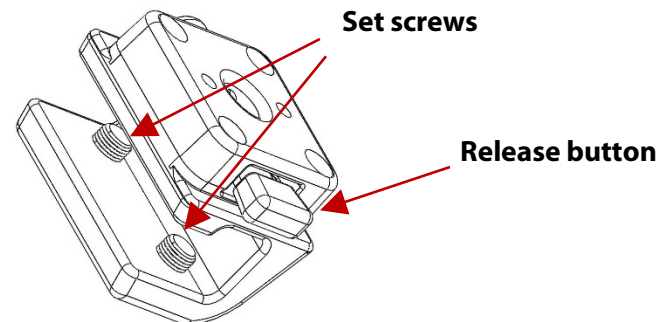

### Picatinny Mount

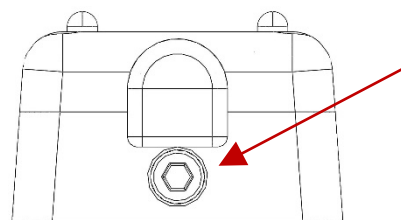

1. Use provided Hex key to remove screw from Picatinny mount.

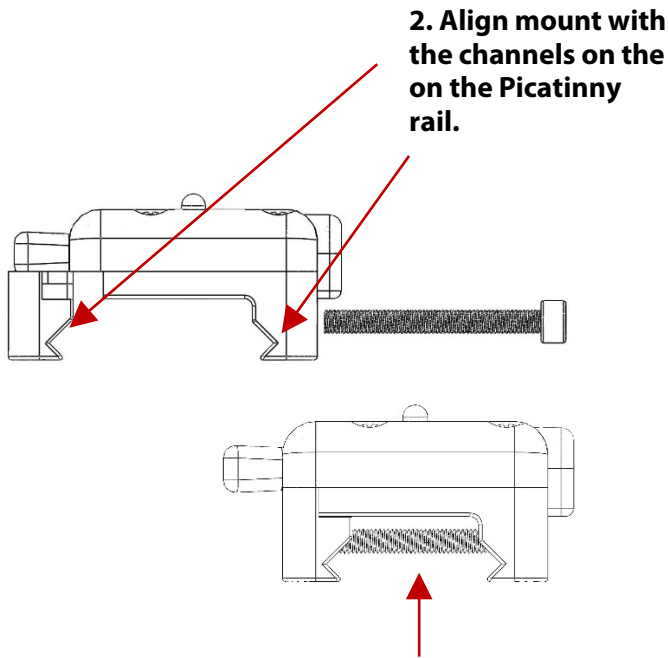

#### Molle mount

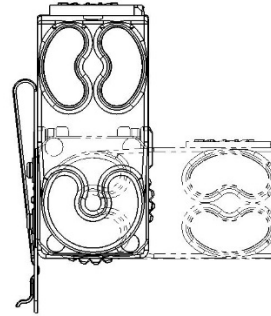
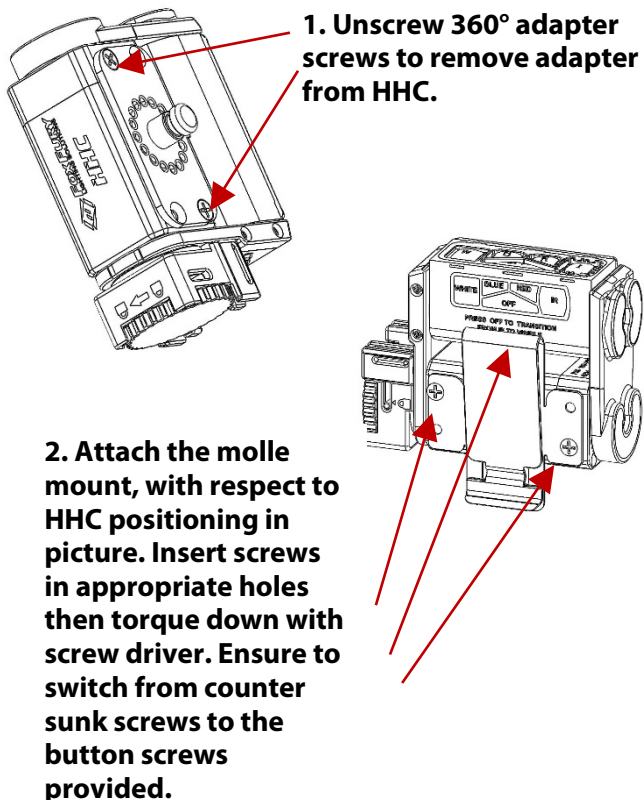

Molle mount can be worn in different positions.

### 3. OPERATION

#### Operational Mode

The markings over the switches indicate as follows:

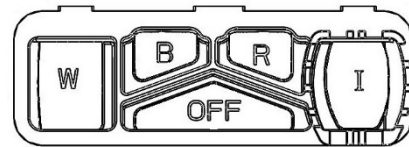

W	White Light
B	Blue Light
R	Red Light
I	IR (Infrared) Light
OFF	

Starting with the unit in OFF position, any switch can be activated.

- If either W, B, or R lights are turned ON, another color (including IR) can be selected by simply pressing the switch.
- To go from IR to W, B, or R, the OFF switch must be pressed first.

**These rules are meant to protect the user from being seen accidentally.**

Each Light has the following operational mode sequence:

Mode	Description
1	100%
2	80%
3	50%
4	20%
5*	3.0Hz
6*	7.0Hz

\*Note for Mode 5 and 6: Blinking at 20% duty cycle.



#### Performance/Light Output:

Light Output varies according to Battery and Mode Selected. Please note as follows:

##### For White Light:

White Light	Lumen Output according to Batteries	
Mode	AA	CR123
1	38	82
2	28	72
3	20	48
4	10	20
5	38	82
6	38	82

##### For Red and Blue Light:

Red & Blue Light	Lumen Output according to Batteries	
Mode	AA	CR123
1	38L	
2	28L	
3	20L	
4	10L	
5	38L	
6	38L	

##### For Infrared Light:

IR Light	Lumen
Mode	mW for AA or CR123 Batteries
1	110mW
2	90mW
3	60mW
4	25mW
5	110mW
6	110mW

- Near Vision - 40° full angle – will allow viewing of the immediate area
- Far Vision - 10° full angle – will allow the user to see distances of 200ft+ (65m+) or be seen from distances of up to 2 miles (3.2 km)

#### LED Window

The LED colors are:

- Blue (leftmost)
- White (second from the left)
- IR (two LEDs on top of each other, barely visible, between White & Red)
- Red (rightmost)

## 4. MAINTENANCE

Your FoxFury is a professional tool, but regular maintenance and care of your light will maximize its performance for you. As needed, wash your FoxFury using a soft washcloth, clean water and a mild soap. Be sure that battery pack is sealed before washing. When done, pat dry with a damp cloth. If your light has been exposed to mud, use a toothbrush under running water to clean.

## 5. ACCESSORIES & REPLACEMENT PARTS

Item	Part Number
HHC Black	199-200
HHC ODG	199-201
Headlamp Mount	60-092
C-Clamp Mount	60-094
Molle Mount	60-093
Elastic Strap	60-019
Picatinny Mount	60-089

## 6. WARNINGS

### IMPORTANT

FoxFury, LLC is not responsible for the incorrect use of any FoxFury Lighting product.

- Lights are strong enough to cause damage to the human eye.
- Do not stare into LEDs for long periods of time or from a close range (less than 2 feet).
- FoxFury, LLC is not responsible for any injury or damage caused during the use of this product.
- Any FoxFury product should be operated at a speed safe enough to maneuver around surrounding obstacles.
- Do not use under the influence of drugs or alcohol.

### INFRARED (IR) LIGHT

- AVOID STARING AT THE LIGHT. WHILE INVISIBLE TO THE HUMAN EYE, IT CAN CAUSE LONG TERM DAMAGE





## 7. WARRANTY AND CUSTOMER CARE

### Warranty

FoxFury Limited Warranty & Customer Care Information

#### LIMITED WARRANTY

FoxFury, LLC ("FoxFury") warrants to the purchaser of this product ("Buyer") that for a period of two years following purchase, this product will be free from defects in material and workmanship and will function in substantial compliance with FoxFury's written specifications for this product as specified in the instruction manual or on FoxFury's website located at [www.foxfury.com](http://www.foxfury.com). Buyer's exclusive remedy shall, in any case, be limited, at FoxFury's election, to: A) repair or replacement of the defective product; or B) refund of the purchase price for this product. THE FOREGOING WARRANTY IS THE ONLY WARRANTY MADE BY FOXFURY WITH RESPECT TO THIS PRODUCT. TO THE EXTENT ALLOWED BY APPLICABLE LAW, THERE ARE NO REPRESENTATIONS OR WARRANTIES OF ANY KIND BY FOXFURY, EXPRESS OR IMPLIED, WITH RESPECT TO THE CONDITION OR PERFORMANCE OF THIS PRODUCT, INCLUDING, BUT NOT LIMITED TO, MERCHANTABILITY OR FITNESS FOR A PARTICULAR PURPOSE.

This limited warranty shall not apply if this product is not stored, handled, installed or used in strict accordance with manufacturer's specifications and instruction manuals, or which has been subject to misuse, alteration, negligence or accident.

1. The damaged part or product must be returned to FoxFury PRIOR TO any repair or replacement. Shipping costs are the responsibility of the claimant.
2. You must obtain a return authorization (RMA) number from FoxFury prior to returning products. FoxFury is not responsible for any damage incurred while in transit.
3. Buyer will be required to show proof of purchase – No Exceptions.
4. Any modifications to light, cable or battery pack automatically voids all warranties on this product.

All warranty inquiries should be directed to FoxFury's Customer Service Department to handle all warranty and repair-related inquiries.

TO THE EXTENT ALLOWED BY APPLICABLE LAW: (A) IN NO EVENT, WHETHER DUE TO BREACH OF WARRANTY HEREUNDER OR ANY OTHER CAUSE WHATSOEVER, SHALL FOXFURY BE LIABLE FOR OR OBLIGATED IN ANY MANNER TO PAY CONSEQUENTIAL, INCIDENTAL OR INDIRECT DAMAGES, INCLUDING, BUT NOT LIMITED TO, LOSS OF PROFITS, COST OF SUBSTITUTE PRODUCTS AND PERSONAL INJURY OR PROPERTY DAMAGE, WHETHER SUCH CLAIM IS BASED ON CONTRACT OR TORT OR ANY OTHER THEORY OF LAW, AND (B) FOXFURY'S ONLY DUTIES IN CONNECTION WITH THE SALE OF THIS PRODUCT SHALL BE TO HONOR THE LIMITED WARRANTY SET FORTH HEREIN. TO THE EXTENT THAT THIS LIMITED WARRANTY IS INCONSISTENT WITH APPLICABLE LAW, THIS STATEMENT SHALL BE DEEMED MODIFIED TO BE CONSISTENT WITH SUCH APPLICABLE LAW.



FoxFury, LLC

Oceanside, CA 92056 USA

Toll-Free: 844-FOXFURY

Tel: 760.945.4231

Fax: 760.433.3650

Email: [custserv@foxfury.com](mailto:custserv@foxfury.com)

[www.FoxFury.com](http://www.FoxFury.com)